

# Knife Sharpener Instructions

## S26武士磨刀器

## Warning 注意事項

- Do not use knife sharpener to sharpen serrated blades or scissors ceramic knife.
  - Using the knife sharpener should grind the knife backward. Do not grind the knife forward to backward direction.
  - Please do not press and sharpen your knife too strongly in case of any damages caused on the blade.
  - Wash the blade after using sharpener.
  - Tungsten carbide blade must keep dry and avoid oxidation.
  - Clean and dry the contact surface before attaching the suction cup.
  - Not suitable surface which are smaller than the rubber pad, or surface with a roughness over 0.4mm.
  - Not suitable for cement wall, marble, granite, wood board, wallpaper, tiles without glaze process, cracked tiles or any porous surface.
  - As rubber pad contains natural oils and it may cause chemical reaction with paint. To avoid getting stains, do not use on any light-colored and breathable surface.
  - To keep the suction cup in good condition, release the lock when it is not in use or attached to the contact surface.
  - Kindly note that we are unable to exchange or refund your products if your merchandise is found to be damaged or abused.
- 本產品不適合磨剪刀、鋸齒刀、陶瓷刀。
  - 請以同一方向往後磨刀，不可來回磨刀。
  - 請勿過度用力重壓磨刀，以免損傷刀刃。
  - 使用後請清洗刀具。
  - 碳化鎢刀片請保持乾燥，避免氧化。
  - 使用前需將吸附面擦拭乾淨，確認牢固吸附後方可使用。
  - 吸附面積需大於吸盤面，凹凸面段差請勿超過0.4mm。
  - 不適用水泥牆面、天然石材、木板、壁紙及有裂縫或無上釉磁磚等透氣之表面。
  - 橡膠墊含有天然油脂，避免使用於淺色、會吸附油脂之透氣表面，以防止油脂殘留。
  - 未吸附狀態請卸除壓板，保持橡膠墊平整。
  - 商品售出後，如經拆封使用導致商品不完整無販售價值時，恕無法退換。

## Installation 使用步驟



Clean and dry the contact surface before attaching the suction cup. Make sure it is firmly attached to the surface before use.

將吸附面擦拭乾淨，以確保最佳吸附力

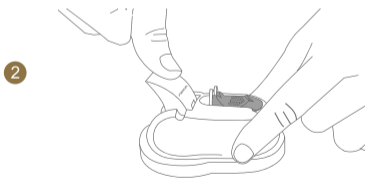

Strongly press and hold the suction cup for 2-3 seconds to remove the air underneath. Push down the lock while pressing on the cup. Make sure it is firmly attached to the surface before use.

吸盤向吸附面按壓2~3秒，使空氣排出，將壓板扣緊至底部，確認完全吸附

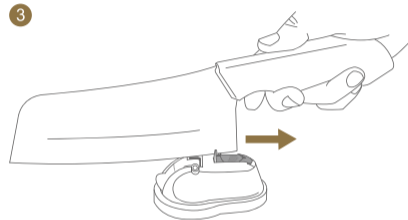

Place the knife in the gap and pull the knife backward. Press the knife slightly strong and you will have more sharper knives.

將刀具置於磨刀片溝槽間，以向後拉的方式(勿來回拉)，稍微施力，即可磨出鋒利的刀刃

## Replace the blade 替換磨刀片

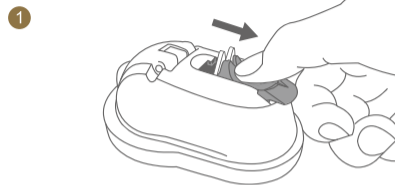

Press and pull the slide cap backward  
按住滑蓋向後拉

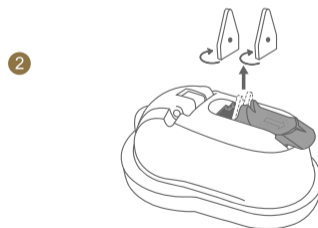

Take out the blade and turn a round of the blade.  
取出磨刀片，並將磨刀片轉向背面

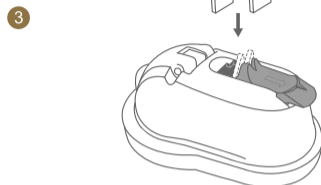

When blade turn a round, place it in the gap.  
將轉向後的磨刀片放回原位

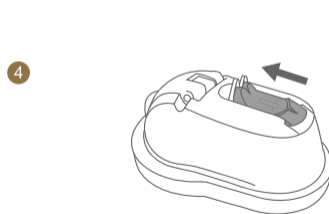

press and push the slide cap to its place.  
再將滑蓋推回原處，即可再次使用