

OVO

OVO 無框電視 K系列智慧投影機

快速安裝指南
Quick Start Guide

展雋創意股份有限公司
Ovomeia Creative Inc.
www.ovotv.com

1

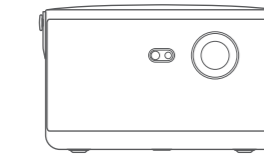

Smart Projector



Remote

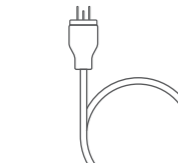

Power Cord

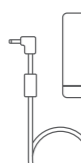

Power Adapter



Battery (AAA)



Quick Start Guide

2

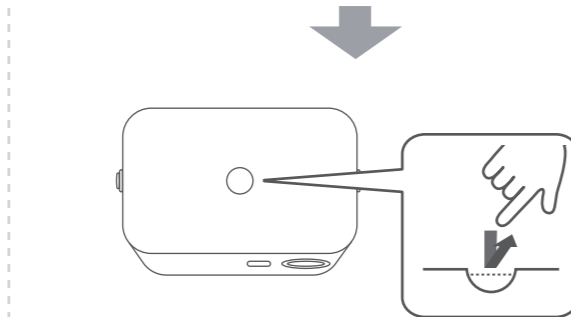
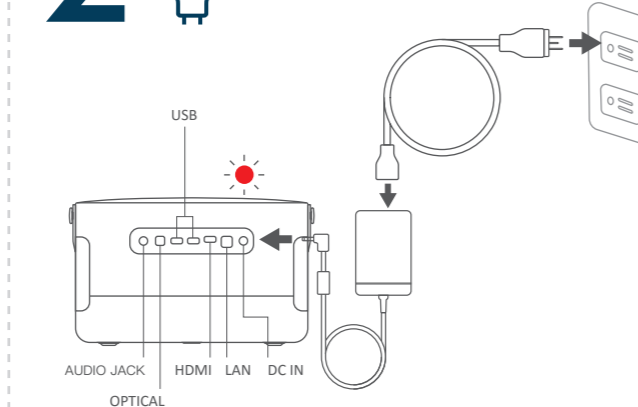

3

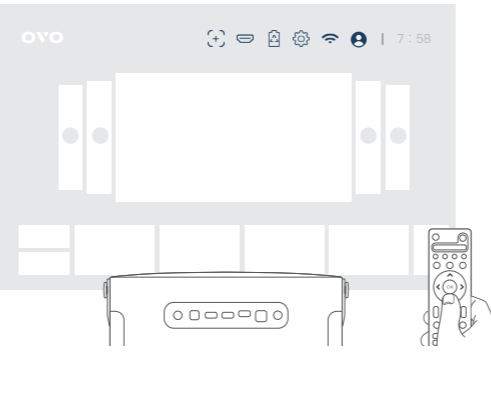
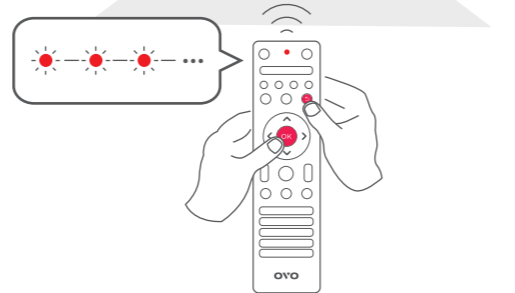
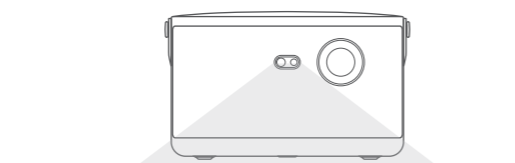
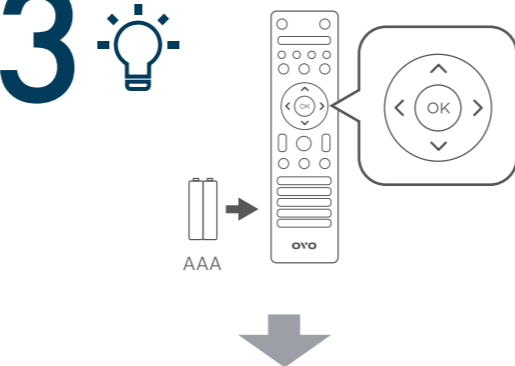

4

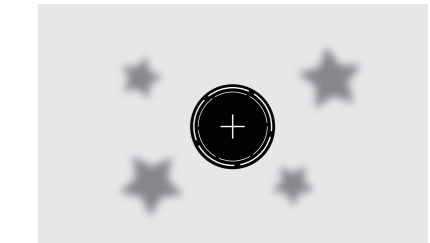
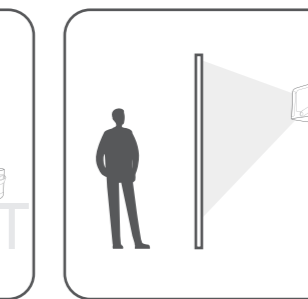
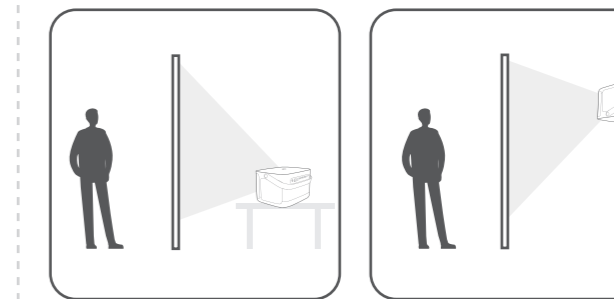
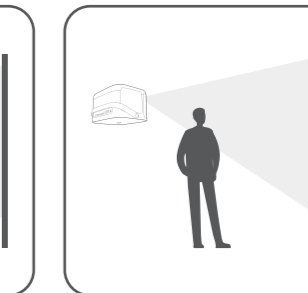
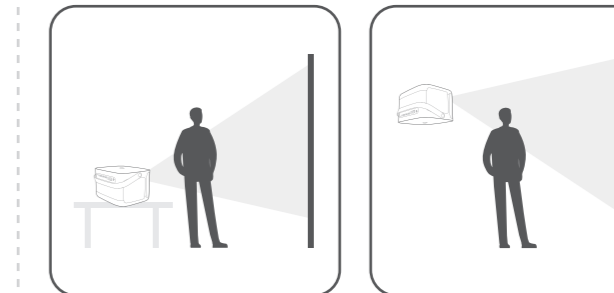
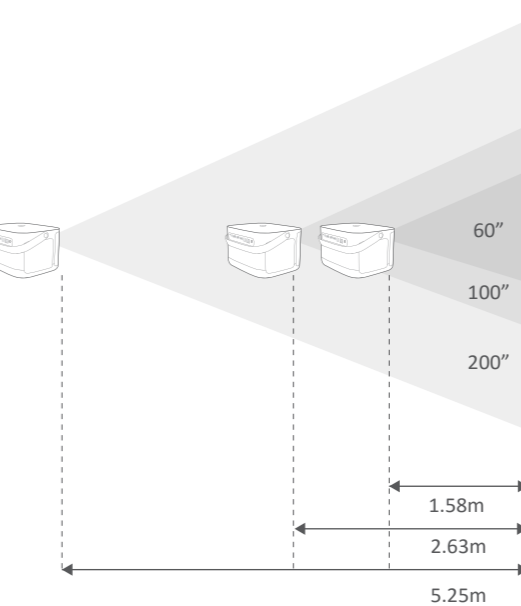

Auto / Manual (+40~-40)

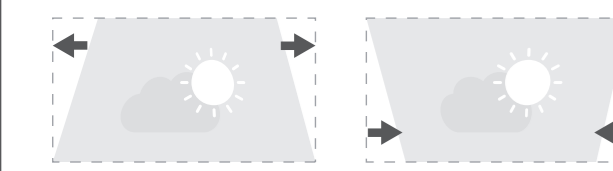

Manual (+40~-40)

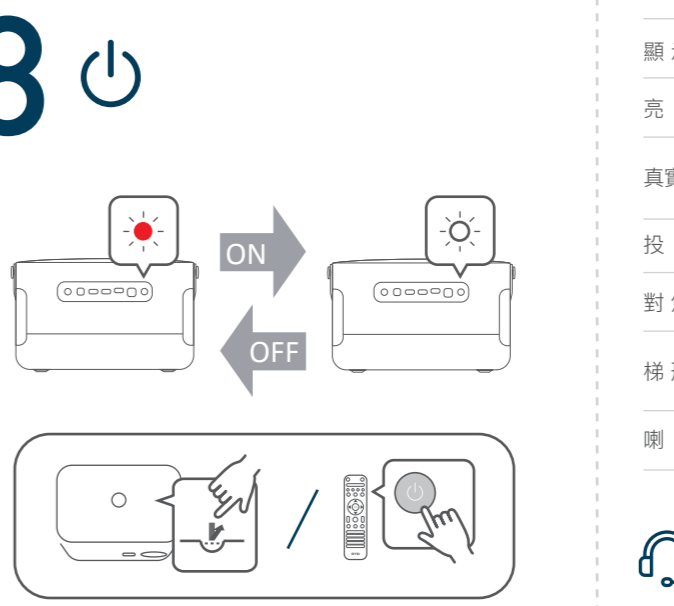
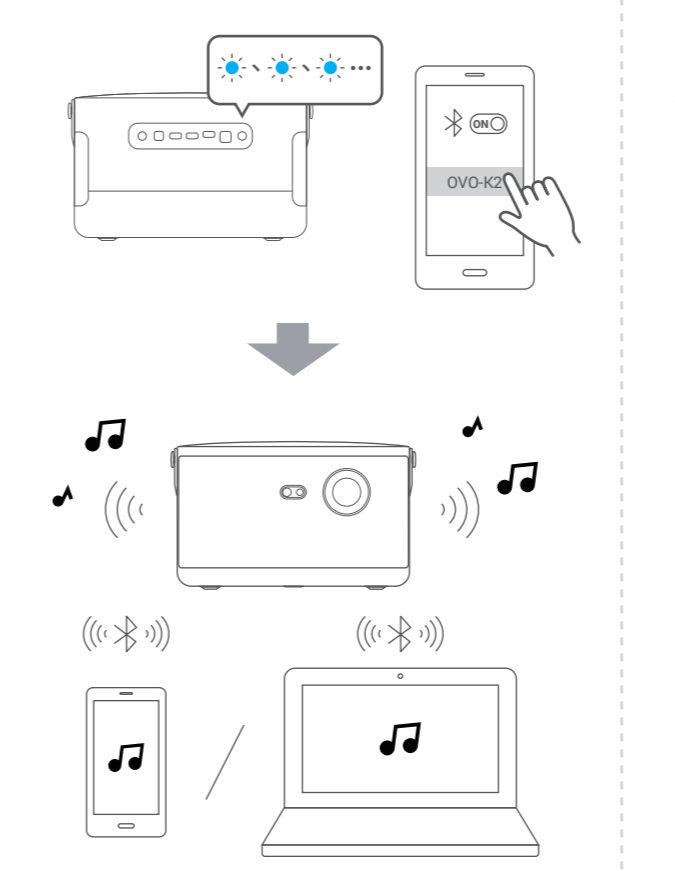
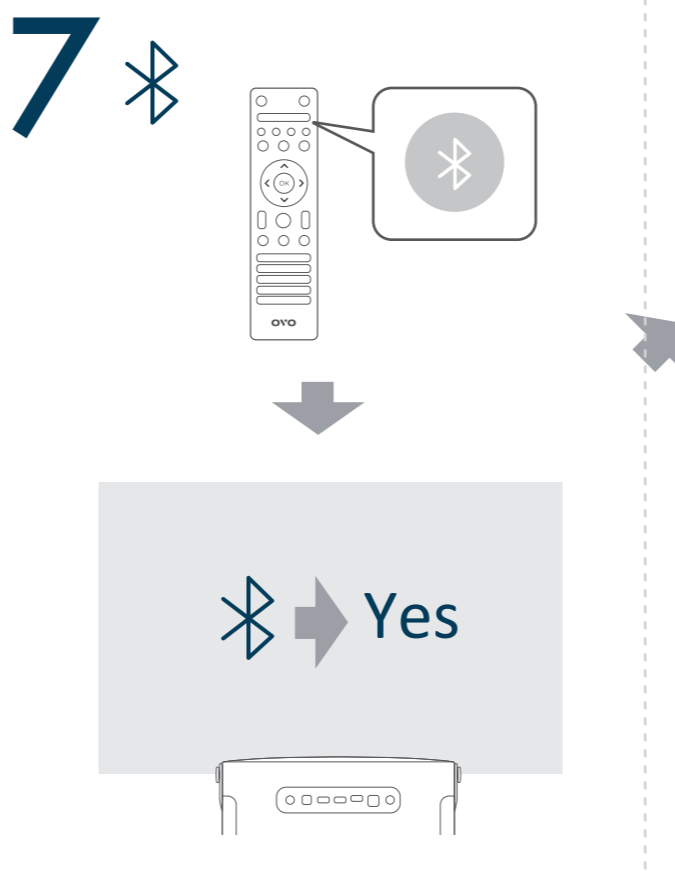
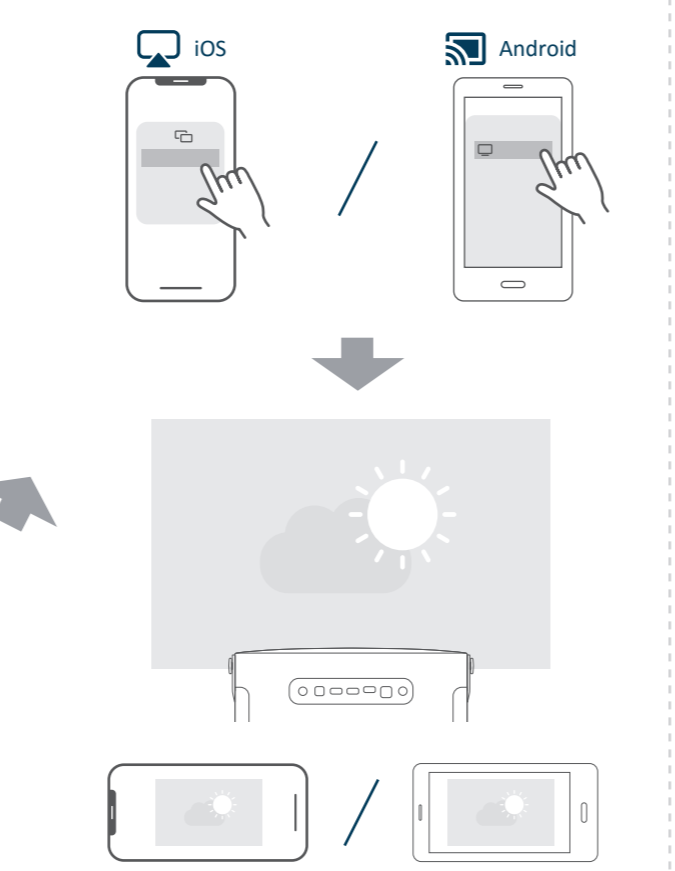
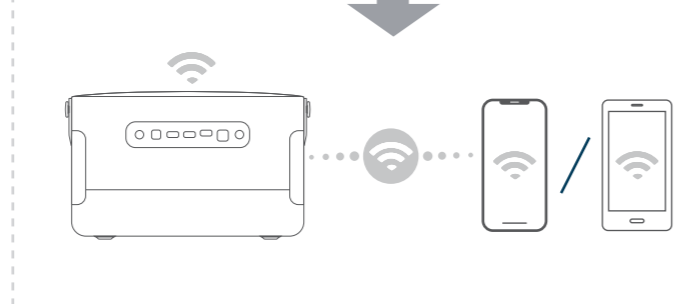
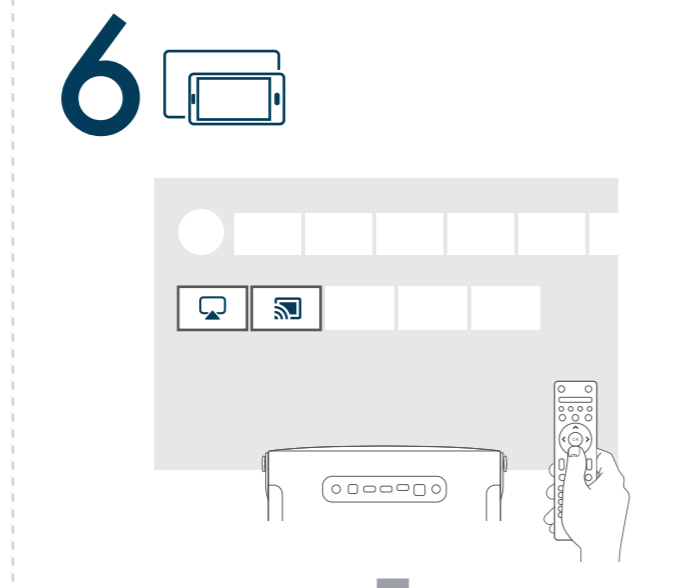
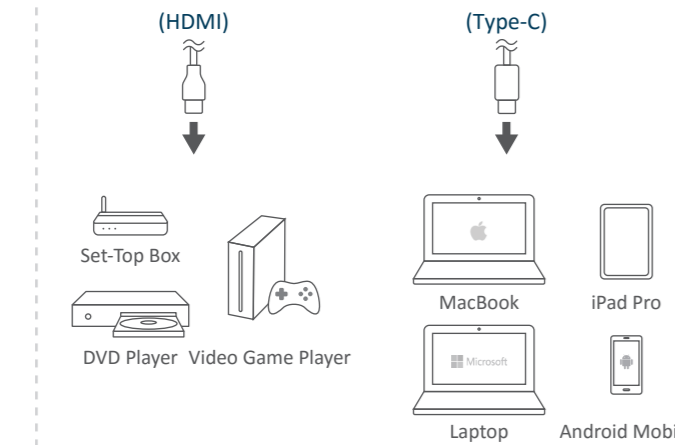
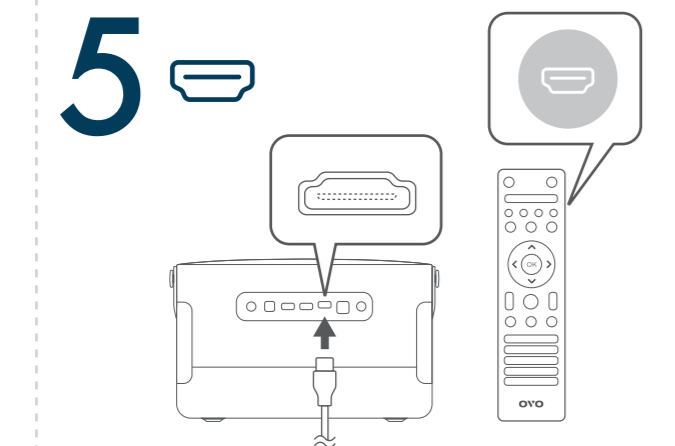
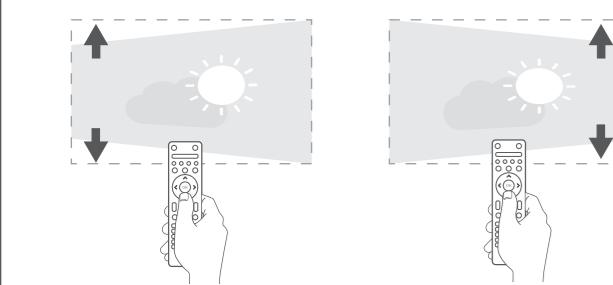

顯示技術	TI DLP
亮度	3500 LED Lumens
真實解析度	真實 1080P (1920x1080) ; 解碼 4K (3840x2160) 60P HDR
投射比	1.2 : 1
對焦模式	自動對焦 (ToF)
梯形校正	垂直自動/手動校正±40度、 水平手動校正±40度
喇叭	5W*2

您可以透過以下管道獲得協助，我們將竭誠為您服務
 Service: ovotv.com/support
 Email: feedback@ovotv.com
 說明書內容如有變動，恕不另行通知。



User Manual

- 開機後不直視光源。
- 不遮蔽進散熱孔，並保持50公分以上的間距。避免曝露於陽光和熱源中。
- 禁止電風扇直吹產品背面的散熱孔。
- 禁止摔落，小心安放。
- 請勿自行拆解或維修，若有問題請洽客服中心。

設備名稱：OVO 智慧投影機 (WiFi+BT) · 型號：OVO-K3 Series
 Declaration of the Presence Condition of the Restricted Substances Marking

單元 Unit	限用物質及其化學符號 Restricted substances and its chemical symbols					
	鉛Lead (Pb)	汞Mercury (Hg)	鎘Cadmium (Cd)	六價鉻 Hexavalent chromium (Cr ⁺)	多溴聯苯 Polybrominated diphenyle (PBB)	多溴二苯醚 Polybrominated diphenyl ethers (PBDE)
外殼	○	○	○	○	○	○
鏡頭	○	○	○	○	○	○
電路板	○	○	○	○	○	○
風扇	○	○	○	○	○	○
電源供應器	○	○	○	○	○	○

備註1: "超出0.1 wt %" 及 "超出0.01 wt %" 係指限用物質之百分比含量超出百分比含量基準值。
 Note 1: "Exceeding 0.1 wt %" and "exceeding 0.01 wt %" indicate that the percentage content of the restricted substance exceeds the reference percentage value of presence condition.
 備註2: "○" 係指該項限用物質之百分比含量未超出百分比含量基準值。
 Note 2: "○" indicates that the percentage content of the restricted substance does not exceed the percentage of reference value of presence.
 備註3: "-" 係指該項限用物質為排除項目。
 Note 3: The "-" indicates that the restricted substance corresponds to the exemption.

- [警語] 根據低功率電波輻射性電機管理辦法：
- 第十二條 經型式認證合格之低功率射頻電機，非經許可，公司、商號或使用者均不得擅自變更頻率、加大功率或變更原設計之特性及功能。
 - 第十四條 低功率射頻電機之使用不得影響飛航安全及干擾合法通信；經發現有干擾現象時，應立即停用，並改善至無干擾時方得繼續使用。前項合法通信，指依電信法規定作業之無線電通信。低功率射頻電機須忍受合法通信或工業、科學及醫療用電波輻射性電機設備之干擾。
 - 根據低功率射頻電機技術規範：4.7.9.1 應避免影響附近雷達系統之操作。4.7.9.2 高增益指向性天線只得應用於固定式點對點系統。