

 **BRITA**



Model One-W/Model One-B

BRITA 瞬熱智能溫控UVC滅菌開飲機

使用說明 Instructions for use



繁體中文保固請掃描



重要安全須知。使用本設備前請仔細閱讀以下安全須知。請將本手冊放在方便拿取之處，以便隨時參閱，以確保安全且正確地使用設備。請務必確保每一位新使用者持有本手冊，以熟悉手冊內容與安全警告。如果未遵守手冊內容操作，我們概不承擔任何責任。

殘餘風險

以下段落說明即使按預期使用本設備也可能發生風險。



電流意外可能危及生命！
接觸帶電零件可能因觸電而有生命危險。

因此，絕緣或個別零件損壞可能危及生命。

如有絕緣零件損壞，應立即關閉電源，並安排維修。

切勿繞過或關閉保險絲。

此設備不得浸水。

請確保帶電零件遠離濕氣，避免發生短路。切勿拉扯電線或手濕時移除插頭。

請避免電源線接觸熱源、濕氣、油、尖銳物品、鋒利邊緣等。請勿夾住或折疊電線。

如果電源線受損，請儘速聯繫BRITA客服中心，以避免發生危險。

請確保插頭在隨手可及之處，以便可隨時中斷電源供應。

請注意，使用後加熱元件的表面溫度可能存在餘溫，請勿觸摸以避免燙傷。

超出預期目的的任何使用或其他類型的使用均被視為誤用，誤用可能會造成潛在的損害。

進行清潔或維護工作前，請先移除設備插頭。在此過程中，請使用者確保每一個接觸點都是未插電狀態。

本設備不適合身體、感官或心智能力不全或缺乏經驗和知識的人使用(包括兒童)，除非負責其安全的人士監督或指導他們使用本設備。請務必監督兒童，確保他們不把本設備當作玩具。



Important safety instructions. Please read these safety instructions carefully before using the appliance. Keep this manual in a convenient place so you can always refer to it for the safe and proper use of the appliance. Please make sure to pass it on to any new owner of this appliance so he can become familiar with it and the safety warnings. No liability will be accepted if the instructions in the manual are not followed.

Residual risks

The following section specifies residual risks that could occur even when the water dispenser is used as intended.



Danger to life from electrical current!

Contact with parts carrying live voltage is an immediate danger to life due to electrical shock.

Damage to the insulation or individual components can therefore be life-threatening.

If the insulation is damaged, switch off the power supply immediately and arrange for repair work.

Never bypass or switch off fuses.

Do not immerse the appliance fully in water.

Keep parts carrying live voltage away from moisture to prevent the risk of short circuit. Never pull the plug using the cord or with wet hands.

Always run the cable so that it cannot come into contact with heat sources, moisture, oil, sharp objects, sharp edges etc. Do not clamp or fold the cord.

If the power cord is damaged, it must be replaced by the manufacturer, its service agent, or similarly qualified persons in order to prevent a hazard.

Ensure that the plug remains readily accessible to be able to disconnect the appliance from the mains supply.
The appliance and its accessible parts become hot during use. Care should be taken to avoid touching heating elements.

Any use beyond the intended purpose or other types of use are considered misuse.
Misuse can cause potential damage.

Unplug the appliance prior to cleaning or maintenance work. In the process, ensure that the user is able to verify at each access point that the appliance still remains unplugged.

This appliance is not intended for use by persons (including children) with reduced physical, sensory or mental capabilities, or lack of experience and knowledge, unless they have been given supervision or instruction concerning use of the appliance by a person responsible for their safety. Children should be supervised to ensure that they do not play with the appliance.

快速使用指南

Quick usage guide

安裝濾芯

Install water filter

1 準備MAXTRA+濾芯

您可以信賴的品質：BRITA每顆MAXTRA+濾芯皆經過高溫蒸氣殺菌處理，以確保極致衛生。請拆除MAXTRA+濾芯包裝(請注意MAXTRA+濾芯可能在經過蒸氣處理過程中產生潮濕現象)。

將冷水注入乾淨的水箱中。將 MAXTRA+濾芯浸泡到冷水中並輕輕搖動去除氣泡。取出 MAXTRA+濾芯並將浸泡過濾芯的水倒掉。



Have your MAXTRA+ water filter ready

For quality you can trust: BRITA conducts hot steam sterilization process for ultimate hygiene in every MAXTRA+ water filter. Remove the protective wrapper from the MAXTRA+ water filter (Note: The MAXTRA+ water filter may be damp from steam sterilization process). Fill the clean water tank with cold water. Immerse the MAXTRA+ water filter in cold water and shake it gently to remove any air bubbles. Remove the MAXTRA+ water filter and discard the used water.

2 安裝MAXTRA+濾芯

將漏斗安裝至水箱中。將 MAXTRA+濾芯裝入漏斗凹槽並向下推至定位加以固定。

Install MAXTRA+ water filter

Insert the funnel into the water tank. Place the MAXTRA+ water filter into the hollow of the funnel and push downwards until it is positioned firmly.

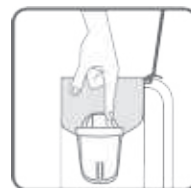

快速使用指南

Quick usage guide

3 向漏斗注水

水箱為可拆卸式設計，注水方式會因您實際需求有所差異。漏斗會自動過濾注入的水，過濾後的水會順勢流入水箱中。



Use funnel to fill the tank with water

Water tank is removable. The filling method depends on your actual needs. The water in the funnel is automatically filtered and flows into the water tank.

4 啓用MAXTRA+濾芯

MAXTRA+濾芯必須經過2次注水才能使用，將前2次注入的水倒掉或用來澆花。經過第3次注水過濾後，MAXTRA+濾芯即可開始正常使用--您可以享受純淨的BRITA過濾水。



若碳微粒滲漏，請先將漏斗沖洗乾淨並參閱「重要須知」的「天然微粒」段落後，再重新裝入濾芯。

Activate the MAXTRA+ water filter

The MAXTRA+ water filter must be filled twice to be activated. Discard the first two fillings or use the water for your plants. With the third filling, the MAXTRA+ water filter is ready for use-you will enjoy clean BRITA filtered water.

In case that carbon particles are released, please rinse the funnel and insert the water filter again. For detailed information about particles, please see paragraph "Natural traces" under "Maintenance and precautions".

快速使用指南

Quick usage guide

日常使用

Daily usage

初次使用請插上電源並啟動電源開關。插上電源後，控制面板螢幕亮3秒後，進入待機模式。

The first time you use the product, please do plug in the power cable and enable the power switch. After plugging in, the control panel will light up for 3 seconds, then machine will be in the standby mode.



- 1 將機器從休眠模式喚醒：輕觸啟動鍵喚醒機器。

Wake up the machine from sleep mode: press start button to wake up the machine.



- 2 解鎖機器：童鎖鍵長按1秒，童鎖燈熄滅即表示解鎖。

Unlock the machine: long press child lock for 1 second, and machine is unlocked when the child lock light is off.

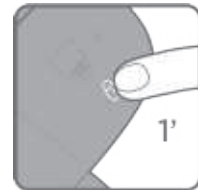

- 3 選擇溫度和出水量：解鎖後機器自動回到上一次使用的溫度與杯子容量設定。請按 +/- 按鍵調整溫度及出水量。

Choose temperature and volume: after unlocking, the machine will automatically return to the last used temperature and cup size settings. You can press +/- button to adjust temperature and volume.



快速使用指南

Quick usage guide

4 出水：請按啟動鍵開始出水。

Release water: press start button to release water.



5 停止出水：出水過程中可按任意鍵停止。

Stop releasing water: Press any button will stop relasing water.

注意：若60秒內無按鍵操作，機器便會自動上鎖且童鎖燈亮起，進入待機模式。若待機模式連續10分鐘無使用，機器便會進入休眠狀態。休眠狀態時，啟動鍵會持續緩慢閃爍，童鎖燈會持續亮燈，而其他按鍵均無法使用。(濾芯更換提醒、缺水提醒、清潔提醒功能指示燈不因休眠狀態影響)



Note: If there is no operation for 60 seconds, the machine will be locked and switches to standby mode. At the same time, the child lock light is on. The machine will switch to sleep mode if there is no operation in 10 minutes under standby mode. Under sleep mode, start button keeps flashing slowly, child lock indicator keeps on and all other buttons are disabled. (The reminders for water filter exchange, empty water tank and machine cleaning will not be affected by sleep mode).

產品結構

Product structure

繁體中文

1. 出水口
2. 矽膠管
3. 不鏽鋼管
4. 加熱器
5. UVC-LED
紫外線殺菌器
6. 導水座
7. 水箱
8. 漏斗
9. 濾芯

EN

1. Water outlet
2. Silicone tube
3. Stainless tube
4. Heater
5. UVC-LED
Ultraviolet disinfectant
6. Base
7. Water tank
8. Funnel
9. Water filter

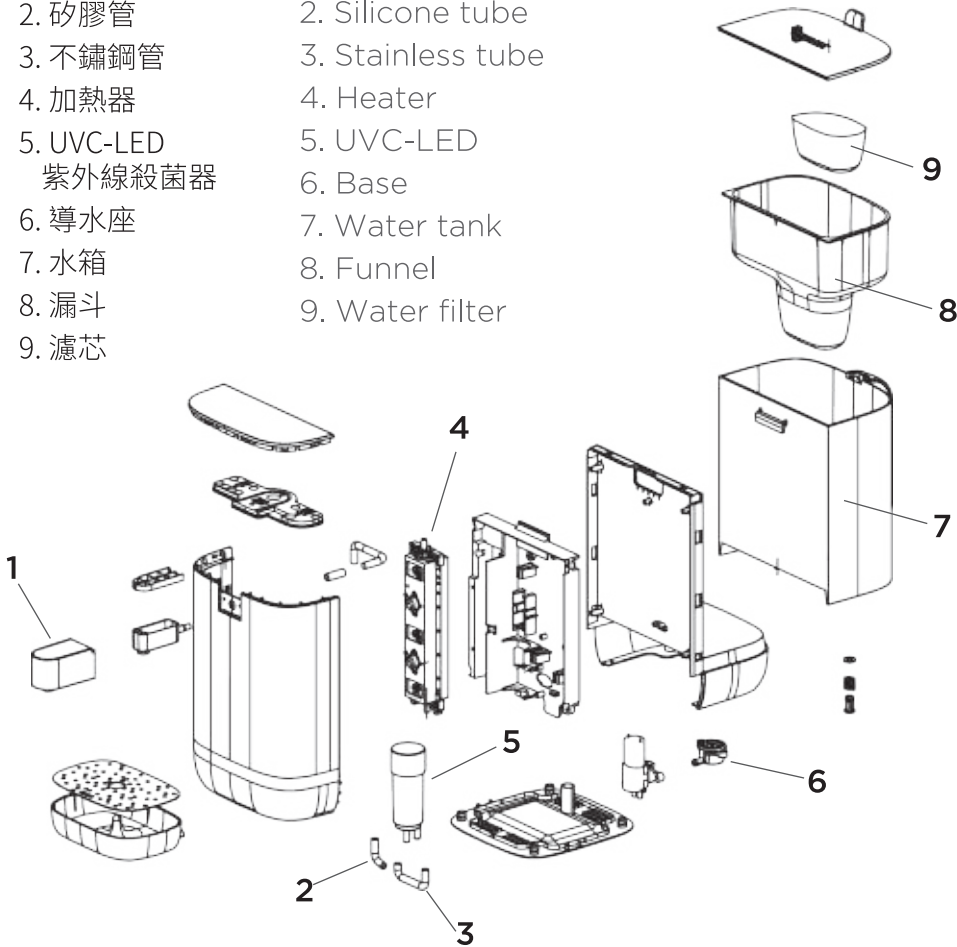

產品操作使用介面

Product operation interface

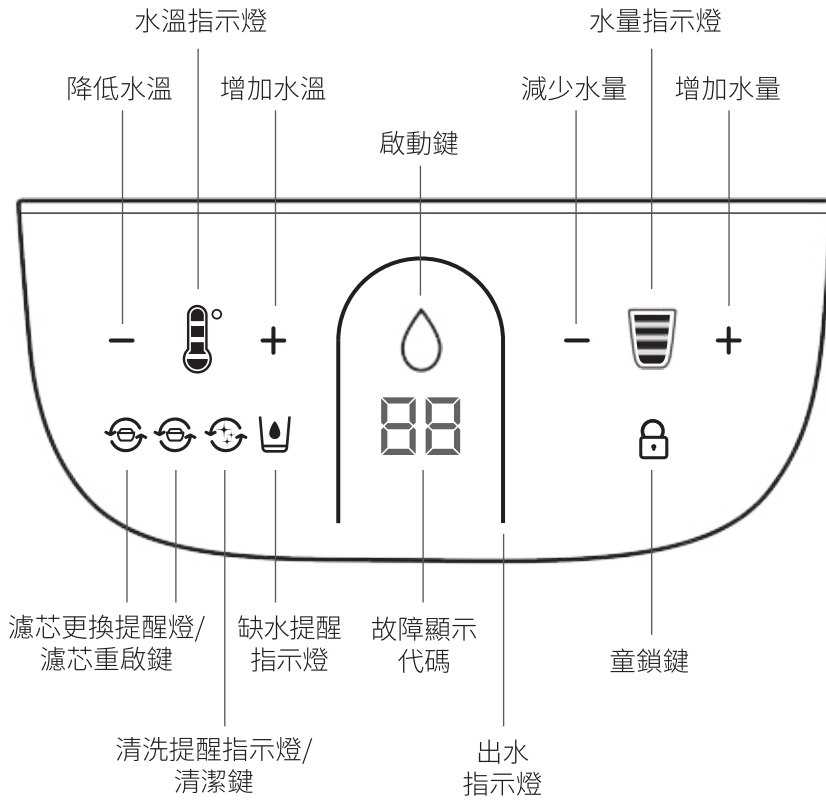

繁體中文

1. 簡介 -----	13
2. 安全指引 -----	16
3. 使用說明 -----	17
4. 疑難排解 -----	24

EN

1. Introduction -----	25
2. Safety instruction -----	28
3. Use instruction -----	30
4. Trouble shooting -----	38

繁體中文

I. 簡介

感謝您選擇BRITA Model ONE 瞬熱智能溫控UVC滅菌開飲機。本產品僅限家庭使用，只需簡單操作，即可依據需求設定溫度與水量，立即享受純淨好水。BRITA以高品質材料製成，並經過定期產品安全與品質測試驗證。

MAXTRA+濾芯結合過流式UVC-LED技術雙重保障，確保每一滴水皆符合標準。

MAXTRA+濾芯採用創新的BRITA MicroFlow Technology微流控制科技，確保更強大的濾水功效* (過濾水可製作成冷飲與熱飲)。

- 減少雜質，如塵土顆粒**
- 從天然椰殼萃取製成活性碳微粒子。活性碳微粒的細小微孔可減少影響氣味與口感的雜質，如氯***、氯胺****、殺蟲劑(林丹、草脫淨)*****與工業汙染物(苯)*****
- 離子交換微粒可防止水垢堆積***保護家電用品，濾除水中鉛、銅***等重金屬。

*與MAXTRA濾芯相比

**由TÜV SÜD China檢驗機構檢驗

***由IWW (Rheinisch-Westfälisches Institut für Wasserforschung) 依據德國DIN EN17093:2018標準檢驗

****由IWW (Rheinisch-Westfälisches Institut für Wasserforschung) 依據NSF 42標準檢驗

*****由IWW依據德國DIN EN17093:2018/NSF 53標準檢驗

過流式UVC-LED，殺菌功效相當於煮沸1分鐘。

- 抑制細菌孳生，防止二次污染*
- 殺滅水中99.999%細菌*

*由TÜV SÜD China檢驗機構檢驗

不鏽鋼厚膜瞬熱技術，5秒瞬熱無需等待。

BRITA以永續環保的作為，改變人們的飲水方式。
使用BRITA產品可積極減少寶特瓶使用，進而
減少廢棄寶特瓶。



超過 50 年濾水技術經驗，為您提供更安心的品質保證

50多年以來，BRITA始終秉持不斷創新與提供最高品質標準的濾水器解決方案。
為確保 BRITA 達到最高品質要求，本公司設置嚴謹的內外部品質控管機制。

出水程序

合格自來水 → 漏斗 → BRITA MAXTRA+濾芯 → 水箱 → UVC-LED → 加熱器
→ 出水口

產品系列外觀差異

產品型號	產品顏色
Model One-W	白色
Model One-B	黑色



II. 安全指引

適用水質範圍

進水：合格自來水

濾水流速：0.25 公升/分鐘

建議濾水量：150公升

濾水壓力：0-0.5MPa

技術規格

濾水流速：0.25 公升/分鐘

建議濾水量：150公升

濾水壓力：0-0.5MPa

額定功率：1500W

加熱功率：1500W

額定電壓/頻率：110V~/60Hz

適用水溫：常溫自來水

進水：合格自來水

重要須知

- 1、MAXTRA+濾芯最多可過濾150公升。為確保最佳濾水效能，請務必每四週更換一次MAXTRA+濾芯。BRITA搭配濾芯更換指示燈，貼心提醒您下次更換濾芯時間。
- 2、請定期清洗水箱，以免堵塞導致機器無法正常運作。
- 3、初次使用或濾芯更換及長時間未使用，建議使用清潔功能沖洗機器，再開始使用。
- 4、請依照使用手冊定期清洗與更換濾芯。
- 5、本開飲機出水含有未經加熱完成之水質，應確實定期更換濾芯並確保水源符合飲用水質標準。
- 6、請使用非顆粒或研磨效果的中性清潔劑清潔機器表面，但務必避免機器進水。
- 7、天然微粒：如同所有天然產品，BRITA 活性碳微粒子 (Micro Carbon Pearls)的耐用度可能會因天然因素而不盡相同。由於可能會有少量小型碳微粒滲入過濾水中，因此水中難免會發現黑色小點。這些微粒對人體健康無任何負面影響。* 如發現水中有碳微粒，BRITA建議反覆沖洗濾芯數次，或沖洗至黑色微粒消失為止。

*由TÜV SÜD檢驗機構依照德國法規LFGB及歐盟法令(EC)No1935/2004規範標準，在檢測後頒予食品級品質認證。

III. 使用說明

請將本開飲機放置於陰涼、通風、穩固的平坦空間，遠離熱源。

為確保飲用水品質，請使用BRITA官方授權正版濾芯。

MAXTRA+濾芯建議最多可過濾150公升。

為確保最佳濾水效能，請務必每四週更換一次MAXTRA+濾芯。
BRITA開飲機搭配濾芯更換提醒指示燈，貼心提醒您下次濾芯更換時間。

濾芯安裝

1. 準備MAXTRA+濾芯

您可以信賴的品質：BRITA每顆MAXTRA+濾芯皆經過高溫蒸氣殺菌處理，以確保極致衛生。請拆除MAXTRA+濾芯包裝(請注意MAXTRA+濾芯可能在經過蒸氣處理過程中產生潮濕現象)。將冷水注入乾淨的水箱中。將MAXTRA+濾芯浸泡到冷水中並輕輕搖動去除氣泡。取出MAXTRA+濾芯並將浸泡過濾芯的水倒掉。



2. 安裝MAXTRA+濾芯

將漏斗裝進水箱。將MAXTRA+濾芯裝入漏斗凹槽並向下推至定位加以固定。



3. 在漏斗注水

水箱為可拆卸式設計。注水方式依您的實際需求而有差異。漏斗會自動過濾注入的水，過濾後的水會順勢流入水箱中。



4. 啟用MAXTRA+濾芯

MAXTRA+濾芯必須經過2次注水才能使用。將前2次注入的水倒掉或用來澆花。經過第3次注水過濾後，MAXTRA+濾芯即可開始正常使用--您可以享受純淨的BRITA過濾水。若碳微粒滲漏，請先將漏斗沖洗乾淨並參閱「重要須知」的「天然微粒」段落後，再重新裝入濾芯。



水箱使用

水箱及水箱上蓋均為可拆卸式設計。

· **移除水箱：**握住水箱把手後垂直向上提起，即可將水箱從機器上移除。



· **安裝水箱：**安裝時將水箱從上往下裝入，確保水箱與機器下方凹槽定位並將背面卡扣加以固定。若水箱未安裝正確，缺水提醒指示燈會持續閃爍。

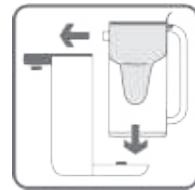

· **移除水箱上蓋：**保持上蓋為闔上狀態，將水箱垂直拿起即可移除水箱上蓋。



· **安裝水箱上蓋：**保持上蓋為水平狀態，垂直由上而下蓋在水箱上即可完成。



注意：水箱上蓋在開啟狀態無法移除。



日常使用

初次使用請插上電源並啟動電源開關。插上電源後，控制面板螢幕亮3秒後，進入待機模式。

1. 將機器從休眠模式喚醒：輕觸啟動鍵喚醒機器。
2. 解鎖機器：童鎖鍵長按1秒，童鎖燈熄滅即表示解鎖。
3. 選擇溫度和出水量：解鎖後機器自動回到上一次使用的溫度與杯子容量設定。請按 +/- 按鍵調整溫度及出水量。
4. 出水：請按啟動鍵開始出水。
5. 停止出水：出水過程中可按任意鍵停止。



注意：若60秒內無按鍵操作，機器便會自動上鎖且童鎖燈亮起，進入待機模式。若待機模式連續10分鐘無使用，機器便會進入休眠狀態。休眠狀態時，啟動鍵會持續緩慢閃爍，童鎖燈會持續亮燈，而其他按鍵均無法使用。



休眠模式

待機模式

(濾芯更換提醒、缺水提醒、清潔提醒功能指示燈不因休眠狀態影響)

機器清潔

機器表面清潔：

請使用非顆粒或研磨效果的中性清潔劑清潔機器表面，但務必避免機器進水。

機器內部管線清潔：

建議在以下情況對機器內部管線徹底清潔。

1. 第 1 次使用
2. 連續使用 3 個月後
3. 長時間停用後恢復使用時

機器內部管線清潔方式：

自動清潔功能：清潔提醒指示燈每3個月會提醒一次。當清潔提醒指示燈亮代表機器需清洗。此時請長按清潔鍵2秒，則啟動自動清潔程序。

- 清潔過程中，清潔鍵會持續閃爍。當清潔程序結束後，清潔提醒指示燈會自動關閉，機器會重新計算清潔週期。
- 清潔過程中，機器常溫水與煮沸水會交替出水，請注意須防止燙傷！
- 整個清潔程序約持續4-5分鐘，出水量約750ml，請在啟動清潔功能前確保水箱中有足夠水量。
- 若欲略過本次清潔程序，請將機器解鎖並長按增加溫度「+」鍵3秒後，清潔提醒指示燈將會熄滅。

手動清潔功能：解鎖機器並長按增加溫度「+」鍵3秒，即可開啟自動清潔功能。並請依照自動清潔程序操作。



注意：若24小時內無任何使用操作，此時機器將自動切換至沸騰溫度，清潔提醒指示燈會持續閃爍。建議您倒掉第一杯煮沸後的水，清潔提醒指示燈隨即自動熄滅，再調整至所需要的溫度設定。



音量調整

為滿足不同消費者需求，BRITA開飲機提供3種音量設定，分別為靜音、中音及高音。











1. 長按童鎖鍵1秒解鎖機器。
2. 長按增加水量「+」鍵3秒，即可調整音量至下一個等級。共3種音量循環調整。

按鍵操作說明

按鍵	操作說明
	<p>童鎖指示燈/童鎖鍵：</p> <p>童鎖指示燈紅燈長按1秒後，指示燈熄滅即解鎖。若60秒內無按鍵操作，童鎖鍵便自動上鎖，童鎖指示燈亮起。</p>
	<p>濾芯更換提醒指示燈/濾芯重啟鍵：</p> <p>濾芯更換提醒亮黃燈代表濾芯已使用21天，紅燈則代表已使用28天。更換濾芯後長按3秒，提醒指示燈即自動熄滅，並重新計算。</p>
	<p>清潔提醒指示燈/清潔鍵：</p> <p>清潔提醒指示燈亮起，長按2秒即啟動自動清潔程序，清潔過程中清潔鍵會持續閃爍，當清潔程序完成後指示燈會自動關閉。</p> <p>手動清潔功能：解鎖機器並長按增加溫度「+」鍵3秒，即可開啟自動清潔功能。並請依照自動清潔程序操作。</p> <p>注意事項：請在清潔程序前將容器放置於出水口下方，以免水流溢出或燙傷，清潔過程中出水量約750ml。</p>

按鍵	操作說明
	<p>啟動鍵：</p> <p>將機器解鎖後，按啟動鍵便開始運轉，並依設定的水溫與水量出水。出水過程中可按任意鍵停止出水。休眠狀態時，啟動鍵會持續緩慢閃爍，輕觸啟動鍵可喚醒機器。</p>
	<p>水溫/水量按鍵+：</p> <p>按此鍵可增加水溫/水量設定。機器解鎖下長按增加溫度「+」鍵3秒，即可開啟自動清潔功能或略過本次清潔程序。長按增加水量「+」鍵3秒，即可調整按鍵音量。</p>
	<p>水溫/水量按鍵-：</p> <p>按此鍵可降低水溫/水量設定</p>

指示燈狀態說明

指示燈	指示燈狀態說明	指示燈	指示燈狀態說明
	150ml水量指示燈		常溫水指示燈
	250ml水量指示燈		45°C水溫指示燈
	350ml水量指示燈		85°C水溫指示燈
	450ml水量指示燈		沸水指示燈
	缺水提醒指示燈		出水指示燈

IV. 疑難排解

故障現象	可能原因	解決對策
E1	高溫保護	停止使用後選擇常溫水
E2	進水NTC異常	請致電BRITA服務專線
E3	出水NTC異常	請致電BRITA服務專線
E4	UVC-LED異常	請致電BRITA服務專線
機器無法運轉	機器處於童鎖狀態	請解除童鎖鍵
機器無法出水	水箱未正確固定	請重新將水箱從上往下裝入，確保安裝到位
	機器處於童鎖狀態	請解除童鎖鍵
出水流速過慢	雜質堵塞進水口連接處	檢查水箱與機器連接處是否堵塞
熱水水溫過低	程式運作未順暢	連續執行4杯100°C熱水，使機器順暢運作至目前環境後即可正常使用

免責聲明

請注意，若您未遵循本使用說明操作產品，BRITA將不承擔任何責任。

請根據當地法規處理機器與使用過的濾芯。

對於BRITA產品及其符合性聲明有任何疑問，請致電BRITA服務專線。

EN

I. Introduction

Hello and thank you very much for choosing water dispenser from BRITA. The product is only for domestic use. With this product, you can instantly get direct drinkable warm water at settled temperature and volume with simple operation. BRITA water dispenser is made from high-quality materials and undergoes regular product safety and quality testing.

The combo of MAXTRA+ water filter and dynamic UVC-LED ensures each drop of water achieve the standard of direct drinkable water.

The MAXTRA+ water filter leverages BRITA MicroFlow Technology and ensures more stunning water filtration* for preparing hot and cold drinks:

- Reduces particles such as sand**
- The small Micro Carbon Pearls are made from carbon of natural coconut shells. Micro-Carbon Pearls lock away taste and odour impairing substances such as chlorine*** and chloramine**** as well as pesticides (lindane, atrazine)***** and industrial pollutants (benzene)***** in its millions of pores
- Ion-Exchange Pearls ensure protection against limescale build-up*** that may occur in domestic appliances and reduces heavy metals such as lead, copper***

* compared to MAXTRA water filter

** Tested by TÜV SÜD China

*** Tested by IWW (Rheinisch-Westfälisches Institut für Wasserforschung) according to DIN EN17093:2018

**** Tested by IWW (Rheinisch-Westfälisches Institut für Wasserforschung) with reference to NSF 42

***** Tested by IWW with reference to DIN EN17093:2018/ NSF 53

Dynamic UVC-LED delivers parity bacteria-killing efficacy with boiling for 1 minute. *

- Inhibit bacterial growth and prevent secondary pollution *
- Kill 99.999% bacteria in water *

* Tested by TÜV SÜD China

Stainless thick film technology allows you get your personalized water in 5 seconds, releasing you from waiting.

We at BRITA are committed to creating a positive and sustainable impact in the world of water. With every BRITA product, you are actively helping to reduce the number of plastic bottles that could end up in the waste.



Over 50 years of experience is a guarantee of quality

For over 50 years, BRITA has stood for constant innovation and the high quality of water filter solutions. To justify high quality requirements at BRITA there are stringent internal and external quality controls.

Product function

Inflow with municipal tap water, after filtered by BRITA Ladoga-W water dispenser, the filtered water conforms to the drinking water standard required by "Standard for hygienic safety and functional evaluation of water quality processors for drinking water - General water quality processors"(2001)

Water treatment process

Municipal tap water → Funnel → BRITA MAXTRA+ water filter → Water tank → UVC-LED → Heater → Water outlet

Appearance discrepancies between product lines

Product model	Product color
Model One-W	White
Model One-B	Black



II. Safty instruction

Applicable water quality range

Inflow water: Municipal tap water

Outflow water: Conforms to the drinking water standard required by "Standard for hygienic safety and functional evaluation of water quality processors for drinking water - General water quality processors"(2001)

Water flowrate: 0.25L/min

Rated filter water capacity: 150L

Inflow water pressure: 0-0.5MPa

Technical specification

Net Water flowrate: 0.25L/min

Rated filter water capacity: 150L

Rated Inflow water pressure: 0-0.5MPa

Rated power: 1500W

Heating power: 1500W

Rated voltage/frequency: 110V-/60Hz

Cold tap water only: 5-38°C

Inflow water: Municipal tap water

Outflow water: Conforms to the drinking water standard required by "Standard for hygienic safety and functional evaluation of water quality processors for drinking water - General water quality processors"(2001)

Maintenance and precautions

1. The MAXTRA+ water filter filters up to 150 liters. To keep the intended performance, you should change your MAXTRA+ water filter every four weeks. To remind you of the next water filter change, your BRITA water dispenser is equipped with a water filter exchange indicator.
 2. Please wash the water tank regularly to avoid any block that causes the machine not to work properly.
 3. When using the water filter for the first time or exchanging the water filter and resuming use after long-term discontinuation, it is recommended to use the cleaning function to wash the machine before making drinking water.
 4. Wash regularly and exchange water filter according to user manual's guidance.
 5. Use any non-abrasive neutral detergent to clean the surface of the machine, but must avoid water entering the machine. Do not immerse the product in water when cleaning.
 6. Natural traces: Like each natural product, the consistency of the BRITA Micro Carbon Pearls is subject to natural variances. This can lead to a slight abrasion of small carbon particles into your filtered water, noticeable as black bits. These particles have no negative health effects.* In case you observe carbon particles, BRITA recommends to flush the water filter several times or until the black bits disappear.
- * Food grade certificate released by TÜV SÜD in accordance with German food law LFGB and European Regulation (EC) No 1935/2004.

III. Use instruction

Please place this water dispenser on a shady, ventilative, stable and flat space. Keep away from heat.

To ensure the quality of drinking water, please use the original BRITA water filter.

The MAXTRA+ water filter can filter up to 150 liters of water.

To keep the intended performance you should change your MAXTRA+ water filter every four weeks. To remind you of the next water filter change, your BRITA water dispenser is equipped with a water filter exchange indicator.

Install water filter

1. Have your MAXTRA+ water filter ready

For quality you can trust: BRITA conducts hot steam sterilization process for ultimate hygiene in every MAXTRA+ water filter. Remove the protective wrapper from the MAXTRA+ water filter. (Note: The MAXTRA+ water filter may be damp from steam sterilization process). Fill the clean water tank with cold water. Immerse the MAXTRA+ water filter in cold water and shake it gently to remove any air bubbles. Remove the MAXTRA+ water filter and discard the used water.



2. Install MAXTRA+ water filter

Insert the funnel into the water tank. Place the MAXTRA+ water filter into the hollow of the funnel and push downwards until it is positioned firmly.

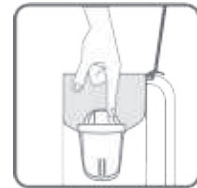

3. Use funnel to fill the tank with water

Water tank is removable. The filling method depends on your actual needs. The water in the funnel is automatically filtered and flows into the water tank.



4. Activate the MAXTRA+ water filter

The MAXTRA+ water filter must be filled twice to be activated. Discard the first two fillings or use the water for your plants. With the third filling the MAXTRA+ water filter is ready for use – you will enjoy clean BRITA filtered water. In case that carbon particles are released, please rinse the funnel and insert the water filter again. For detailed information about particles, please see paragraph “natural traces” under “Maintenance and precautions”.



Water tank usage

Both water tank and lid are removable.

- **Remove water tank:** Hold the handle and then lift straight up, then water tank can be removed.
- **Install water tank:** When installing, load the water tank from the top down, and make sure the hook on the back of water tank is well fit with the groove on machine. when water tank is not well installed, empty water tank indicator will keep flashing.

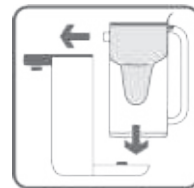

- **Remove tank lid:** keep the lid closed and lift straight up, then the tank lid can be removed.
- **Install tank lid:** Keep lid horizontal and put on to water tank from top down.

Note: Lid is not removable when it's open.



Daily usage

The first time you use the product, please do plug in the power cable and enable the power switch. After plugging in, the control panel will light up for 3 seconds, then machine will be in the standby mode.

- 1. Wake up the machine from sleep mode:** press Start button to wake up the machine.
- 2. Unlock the machine:** long press child lock for 1 second, and machine is unlocked when the child lock light is off.
- 3. Choose temperature and volume:** after unlocking, the machine will automatically return to the last used temperature and cup size settings. You can press +/- button to adjust temperature and volume.
- 4. Release water:** press start button to release water.
- 5. Stop releasing water:** press any button will stop releasing water.

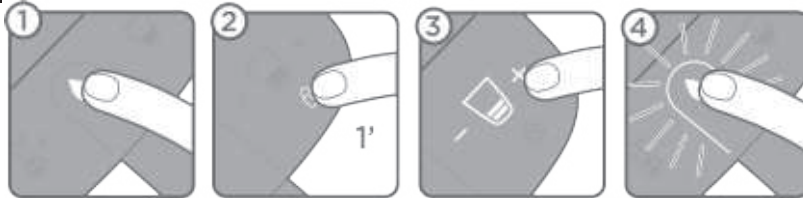

Note: If there is no operation for 60 seconds, the machine will be locked and switches to standby mode. At the same time, the child lock light is on. The machine will switch to sleep mode if there is no operation in 10 minutes under standby mode. Under sleep mode, start button 32 keeps flashing slowly, child lock Sleep mode Standby mode indicator keeps on and all other buttons are disabled.



Sleep mode Standby mode

(The reminders for water filter exchange, empty water tank and machine cleaning will not be affected by sleep mode)

Machine cleaning

Machine surface cleaning

Use any non-abrasive neutral detergent to clean the surface of the machine, but must avoid water entering the machine.

Machine inner tube cleaning

We suggest to do thorough clean in below situations

- 1st time usage
- Continuously used for 3 months
- Re-use after stop using for long time

Machine inner tube cleaning process

Auto clean: Self-cleaning button will remind every 3 months. When the light is on, it means that machine need to be cleaned. Long press self-cleaning button for 2 seconds, then self-cleaning process will start automatically.

- During the cleaning process, the machine cleaning light will keep flashing. Once done, machine cleaning light will turn off automatically and machine will start a new round cleaning leadtime calculation.
- During cleaning process, machine will alternately release room temperature water and boiled water, please pay attention to avoid scalding injury.
- The whole cleaning process will last for 4-5 minutes and use up about 750ml water, please make sure there is enough water in the water tank before start the machine cleaning process.
- If you decide to skip this round machine cleaning, please unlock machine and long-press temperature + button for 3 seconds until self-cleaning button light off.

Manual clean: Unlock the machine and long-press temperature + button for 3 seconds, self-cleaning function will be waken up. Then follow self-cleaning process.



Note: The machine will automatically switch to boiling temperature if there is no operation within 24 hours and self-clean button will keep flashing. Suggest to discard 1st cup of boiled water, and then adjust to your desired temperature setting. After discard 1st cup of boiled water, self-clean button will light off automatically.



Sound adjustment

To fulfill different consumer needs, BRITA water dispenser offers 3 sound volume levels, i.e. mute, medium volume, and high volume.

1. Long-press child lock for 1 seconds to unlock machine
2. Long-press water volume "+" button for 3 seconds, then sound will move to next level. Sound will circulate within 3 sound level.











Operation button description

Operation	Button description
	<p>Child lock indicator/button:</p> <p>Long press for 1 second under red light, the machine will be unlocked when the child lock indicator is off. If there is no operation for 60 seconds, the child lock will be automatically locked and the child lock indicator will turn on.</p>
	<p>Water filter exchange indicator/water filter reset button:</p> <p>Yellow light indicates that water filter has been used for 21 days and red light means 28 days. Long press for 3 seconds after exchanging water filter, the light will be off automatically and it starts calculating time for the new water filter.</p>

Operation	Button description
	<p>Self-clean indicator/button:</p> <p>When it is on, long-pressing for 2 seconds can automatically start self-cleaning process, the light will keep flashing during cleaning. And when the cleaning process finished, it will be automatically off.</p> <p>Manual clean: Unlock machine and long-press temperature + button for 3 seconds, then the self-cleaning function will be waken up. Then follow self-cleaning process.</p> <p>Note: Please place container under water outlet before starting the machine cleaning process to avoid water spilling over or scalding. It will release about 750ml water during the whole cleaning process.</p>
	<p>Start button:</p> <p>Press this button, then the machine will start working and releasing water with settled temperature and volume. When machine is releasing water, press any button will stop the process. When machine is under sleep mode, this button will flash slowly and press this button will wake up machine.</p>

Operation	Button description
+	<p>Water temperature/volume button +:</p> <p>Press to increase temperature or volume. When the machine is unlocked, long-pressing temperature + for 3 seconds will wake up self-cleaning function or skip this round self-cleaning. Long-pressing volume + for 3 seconds can adjust sound volume.</p>
-	<p>Water temperature/volume button - :</p> <p>Press to decrease temperature or volume.</p>

Indicator instruction

Indicator	Description	Indicator	Description
	150ml Volume indicator		Room temperature indicator
	250ml Volume indicator		45°C Indicator
	350ml Volume indicator		85°C Indicator
	450ml Volume indicator		Boiled water indicator
	Empty water tank indicator		Water releasing indicator

IV. Trouble Shooting

Problem	Possible reason	Potential solution
E1	High temperature protection	After stopping the operation, choose room temperature water
E2	Water inlet NTC issue	Contact local BRITA customer service team
E3	Water outlet NTC issue	Contact local BRITA customer service team
E4	UVC-LED issue	Contact local BRITA customer service team
Machine is not working	Machine is locked	Unlock child lock
Machine is not producing water	The water tank has not been pressed in all the way	Press down water tank to make sure it well installed
	Machine is locked	Unlock child lock
The water flow rate is too slow	Water inlet is blocked by impurities	Check whether the connection between the water tank and the machine is blocked
The hot water temperature is too low	The internal computer program of the machine has not been adjusted	Run 4 cups of 100°C hot water so that the machine adapts to the current environment, and afterwards, it can be used normally

設備名稱：BRITA瞬熱智能溫控UVC滅菌開飲機

Equipment name

型號 (型式)： Model One-W

Type designation (Type) Model One-B

單元Unit	限用物質及其化學符號 Restricted substances and its chemical symbols					
	鉛Lead (Pb)	汞Mercury (Hg)	鎘Cadmium (Cd)	六價鉻 Hexavalent chromium (Cr ⁺⁶)	多溴聯苯 Polybrominated biphenyls (PBB)	多溴二苯醚 Polybrominated diphenyl ethers (PBDE)
外殼	○	○	○	○	○	○
面板	○	○	○	○	○	○
水箱	○	○	○	○	○	○
電源線	○	○	○	○	○	○
加熱裝置	○	○	○	○	○	○

備考1.「超出0.1wt %」及「超出0.01wt %」係指限用物質之百分比含量超出百分比含量基準值。

Note 1: "Exceeding 0.1 wt %" and "exceeding 0.01 wt %" indicate that the percentage content of the restricted substance exceeds the reference percentage value of presence condition.

備考2.「○」係指該項限用物質之百分比含量未超出百分比含量基準值。

Note 2: "○" indicates that the percentage content of the restricted substance does not exceed the percentage of reference value of presence.

備考3.「—」係指該項限用物質為排除項目。

Note 3: The "—" indicates that the restricted substance corresponds to the exemption.

1051615-02-MYS 11/22