



Battery Installation:

This product is powered by 3 x AG13 1.5V or 3 x LR44 1.5V batteries.

To insert the batteries, follow the illustration in below and operate:

1. Use a cross screwdriver to unscrew the screw counterclockwise (part 1);
2. Toggle the buckle to open the battery cover (part 2);
3. Insert new batteries - taking note to use the correct polarity (+ and -)(part 3);
4. After confirming that the battery is installed correctly, put back the battery cover and tighten the fixing screw clockwise (part 4);



Important:

Please make sure that the battery-compartment is securely sealed before you use, or water may seep in causing electric leakage or short circuit, which shall not hurt your child but will probably damage the toy.

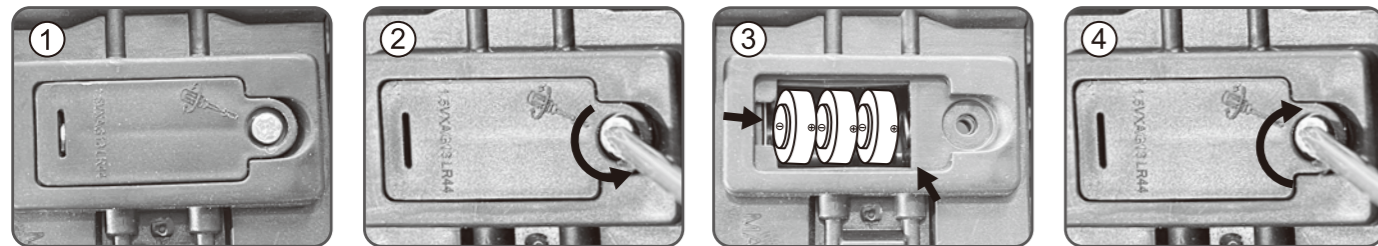

Precautions for battery use:

- Please install the batteries using the correct polarity.
- Non-rechargeable batteries must not be recharged.
- Please take the rechargeable batteries out of the toy before charging.
- Please charge the rechargeable batteries under the supervision of an adult.
- Do not mix different types of batteries or new and used ones.
- Different types of old and new batteries cannot be charged at the same time.
- Do not mix alkaline, standard (carbon-zinc), or rechargeable batteries.
- Do not put the battery into a fire, which may cause it to burst or fall.
- Remove from the toy after the battery has been used up.
- Flat or dead batteries should be removed from the toy.
- Please remove the batteries if the toy is not going to be used for long time, or the leakage of the battery might cause rust or corrosion, which may damage the toy.
- Please replace the batteries when the toy won't work, re-activates frequently, or when its music weakened.
- Please be careful that the terminals of the batteries are not short-circuited.
- Protect the toy from water or dampness.
- Ensure power is turned off before changing batteries, and the battery changing must be done by an adult.
- The batteries are not included in this package, please purchase separately.
- Please dispose of the batteries or broken electronic products at an approved collection point. Such products cannot be disposed together with household waste.

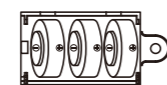
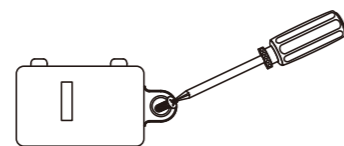

Uses 3X1.5V AG13 OR LR44 batteries (Not Included)



Please keep this instruction manual safe for future reference!



Battery Installation:

This product is powered by 3 x AG13 1.5V or 3 x LR44 1.5V batteries.

To insert the batteries, follow the illustration in below and operate:

1. Use a cross screwdriver to unscrew the screw counterclockwise (part 1);
2. Toggle the buckle to open the battery cover (part 2);
3. Insert new batteries - taking note to use the correct polarity (+ and -)(part 3);
4. After confirming that the battery is installed correctly, put back the battery cover and tighten the fixing screw clockwise (part 4);



Important:

Please make sure that the battery-compartment is securely sealed before you use, or water may seep in causing electric leakage or short circuit, which shall not hurt your child but will probably damage the toy.

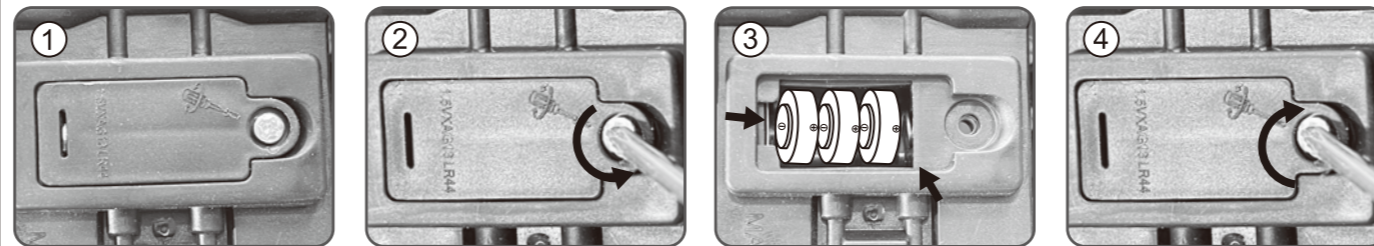

Precautions for battery use:

- Please install the batteries using the correct polarity.
- Non-rechargeable batteries must not be recharged.
- Please take the rechargeable batteries out of the toy before charging.
- Please charge the rechargeable batteries under the supervision of an adult.
- Do not mix different types of batteries or new and used ones.
- Different types of old and new batteries cannot be charged at the same time.
- Do not mix alkaline, standard (carbon-zinc), or rechargeable batteries.
- Do not put the battery into a fire, which may cause it to burst or fall.
- Remove from the toy after the battery has been used up.
- Flat or dead batteries should be removed from the toy.
- Please remove the batteries if the toy is not going to be used for long time, or the leakage of the battery might cause rust or corrosion, which may damage the toy.
- Please replace the batteries when the toy won't work, re-activates frequently, or when its music weakened.
- Please be careful that the terminals of the batteries are not short-circuited.
- Protect the toy from water or dampness.
- Ensure power is turned off before changing batteries, and the battery changing must be done by an adult.
- The batteries are not included in this package, please purchase separately.
- Please dispose of the batteries or broken electronic products at an approved collection point. Such products cannot be disposed together with household waste.

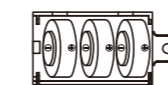
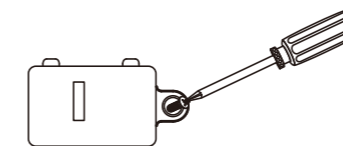

Uses 3X1.5V AG13 OR LR44 batteries (Not Included)



Please keep this instruction manual safe for future reference!



Battery Installation:

This product is powered by 3 x AG13 1.5V or 3 x LR44 1.5V batteries.

To insert the batteries, follow the illustration in below and operate:

1. Use a cross screwdriver to unscrew the screw counterclockwise (part 1);
2. Toggle the buckle to open the battery cover (part 2);
3. Insert new batteries - taking note to use the correct polarity (+ and -)(part 3);
4. After confirming that the battery is installed correctly, put back the battery cover and tighten the fixing screw clockwise (part 4);



Important:

Please make sure that the battery-compartment is securely sealed before you use, or water may seep in causing electric leakage or short circuit, which shall not hurt your child but will probably damage the toy.

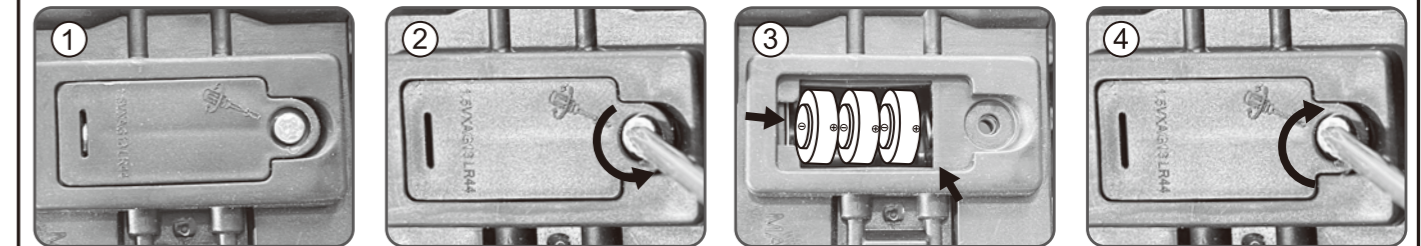

Precautions for battery use:

- Please install the batteries using the correct polarity.
- Non-rechargeable batteries must not be recharged.
- Please take the rechargeable batteries out of the toy before charging.
- Please charge the rechargeable batteries under the supervision of an adult.
- Do not mix different types of batteries or new and used ones.
- Different types of old and new batteries cannot be charged at the same time.
- Do not mix alkaline, standard (carbon-zinc), or rechargeable batteries.
- Do not put the battery into a fire, which may cause it to burst or fall.
- Remove from the toy after the battery has been used up.
- Flat or dead batteries should be removed from the toy.
- Please remove the batteries if the toy is not going to be used for long time, or the leakage of the battery might cause rust or corrosion, which may damage the toy.
- Please replace the batteries when the toy won't work, re-activates frequently, or when its music weakened.
- Please be careful that the terminals of the batteries are not short-circuited.
- Protect the toy from water or dampness.
- Ensure power is turned off before changing batteries, and the battery changing must be done by an adult.
- The batteries are not included in this package, please purchase separately.
- Please dispose of the batteries or broken electronic products at an approved collection point. Such products cannot be disposed together with household waste.

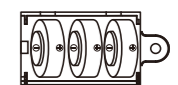
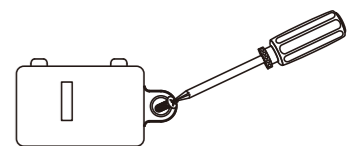

Uses 3X1.5V AG13 OR LR44 batteries (Not Included)



Please keep this instruction manual safe for future reference!



Battery Installation:

This product is powered by 3 x AG13 1.5V or 3 x LR44 1.5V batteries.

To insert the batteries, follow the illustration in below and operate:

1. Use a cross screwdriver to unscrew the screw counterclockwise (part 1);
2. Toggle the buckle to open the battery cover (part 2);
3. Insert new batteries - taking note to use the correct polarity (+ and -)(part 3);
4. After confirming that the battery is installed correctly, put back the battery cover and tighten the fixing screw clockwise (part 4);



Important:

Please make sure that the battery-compartment is securely sealed before you use, or water may seep in causing electric leakage or short circuit, which shall not hurt your child but will probably damage the toy.

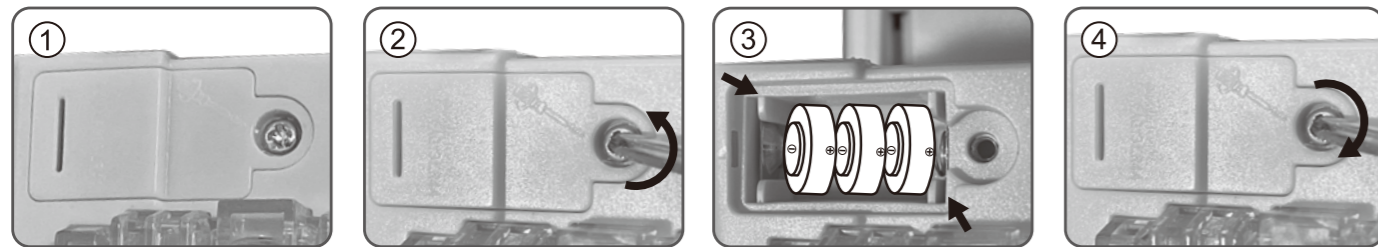

Precautions for battery use:

- Please install the batteries using the correct polarity.
- Non-rechargeable batteries must not be recharged.
- Please take the rechargeable batteries out of the toy before charging.
- Please charge the rechargeable batteries under the supervision of an adult.
- Do not mix different types of batteries or new and used ones.
- Different types of old and new batteries cannot be charged at the same time.
- Do not mix alkaline, standard (carbon-zinc), or rechargeable batteries.
- Do not put the battery into a fire, which may cause it to burst or fall.
- Remove from the toy after the battery has been used up.
- Flat or dead batteries should be removed from the toy.
- Please remove the batteries if the toy is not going to be used for long time, or the leakage of the battery might cause rust or corrosion, which may damage the toy.
- Please replace the batteries when the toy won't work, re-activates frequently, or when its music weakened.
- Please be careful that the terminals of the batteries are not short-circuited.
- Protect the toy from water or dampness.
- Ensure power is turned off before changing batteries, and the battery changing must be done by an adult.
- The batteries are not included in this package, please purchase separately.
- Please dispose of the batteries or broken electronic products at an approved collection point. Such products cannot be disposed together with household waste.

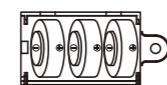
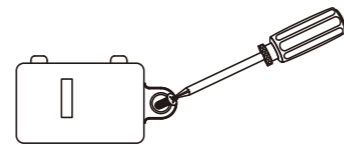

Uses 3X1.5V AG13 OR LR44 batteries (Not Included)



Please keep this instruction manual safe for future reference!



Battery Installation:

This product is powered by 3 x AG13 1.5V or 3 x LR44 1.5V batteries.

To insert the batteries, follow the illustration in below and operate:

1. Use a cross screwdriver to unscrew the screw counterclockwise (part 1);
2. Toggle the buckle to open the battery cover (part 2);
3. Insert new batteries - taking note to use the correct polarity (+ and -)(part 3);
4. After confirming that the battery is installed correctly, put back the battery cover and tighten the fixing screw clockwise (part 4);



Important:

Please make sure that the battery-compartment is securely sealed before you use, or water may seep in causing electric leakage or short circuit, which shall not hurt your child but will probably damage the toy.

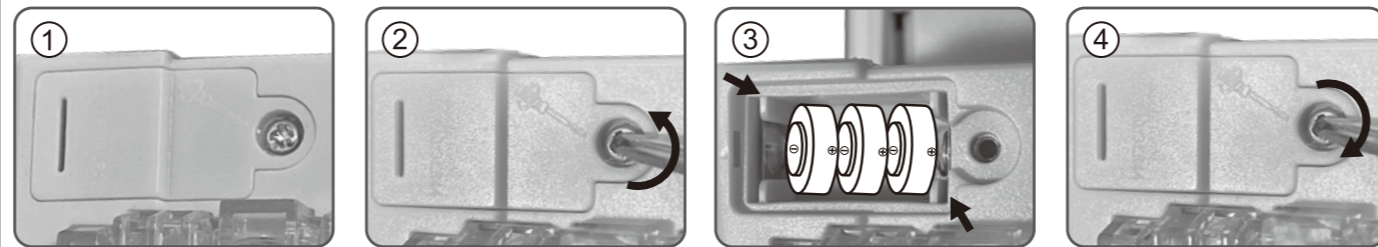

Precautions for battery use:

- Please install the batteries using the correct polarity.
- Non-rechargeable batteries must not be recharged.
- Please take the rechargeable batteries out of the toy before charging.
- Please charge the rechargeable batteries under the supervision of an adult.
- Do not mix different types of batteries or new and used ones.
- Different types of old and new batteries cannot be charged at the same time.
- Do not mix alkaline, standard (carbon-zinc), or rechargeable batteries.
- Do not put the battery into a fire, which may cause it to burst or fall.
- Remove from the toy after the battery has been used up.
- Flat or dead batteries should be removed from the toy.
- Please remove the batteries if the toy is not going to be used for long time, or the leakage of the battery might cause rust or corrosion, which may damage the toy.
- Please replace the batteries when the toy won't work, re-activates frequently, or when its music weakened.
- Please be careful that the terminals of the batteries are not short-circuited.
- Protect the toy from water or dampness.
- Ensure power is turned off before changing batteries, and the battery changing must be done by an adult.
- The batteries are not included in this package, please purchase separately.
- Please dispose of the batteries or broken electronic products at an approved collection point. Such products cannot be disposed together with household waste.

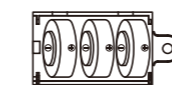
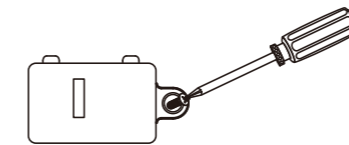

Uses 3X1.5V AG13 OR LR44 batteries (Not Included)



Please keep this instruction manual safe for future reference!



Battery Installation:

This product is powered by 3 x AG13 1.5V or 3 x LR44 1.5V batteries.

To insert the batteries, follow the illustration in below and operate:

1. Use a cross screwdriver to unscrew the screw counterclockwise (part 1);
2. Toggle the buckle to open the battery cover (part 2);
3. Insert new batteries - taking note to use the correct polarity (+ and -)(part 3);
4. After confirming that the battery is installed correctly, put back the battery cover and tighten the fixing screw clockwise (part 4);



Important:

Please make sure that the battery-compartment is securely sealed before you use, or water may seep in causing electric leakage or short circuit, which shall not hurt your child but will probably damage the toy.

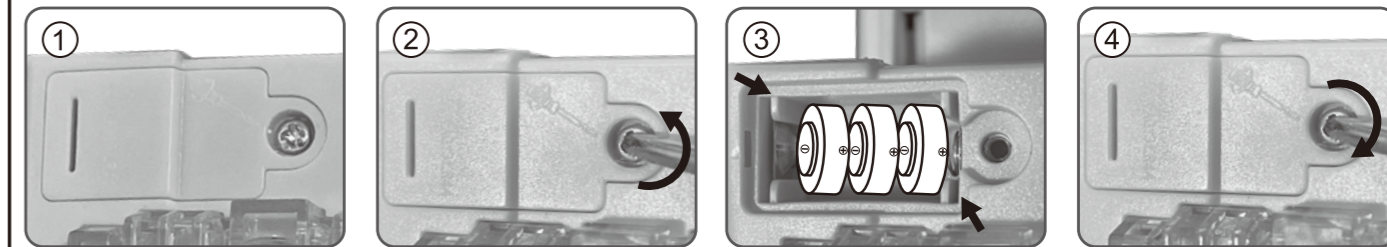

Precautions for battery use:

- Please install the batteries using the correct polarity.
- Non-rechargeable batteries must not be recharged.
- Please take the rechargeable batteries out of the toy before charging.
- Please charge the rechargeable batteries under the supervision of an adult.
- Do not mix different types of batteries or new and used ones.
- Different types of old and new batteries cannot be charged at the same time.
- Do not mix alkaline, standard (carbon-zinc), or rechargeable batteries.
- Do not put the battery into a fire, which may cause it to burst or fall.
- Remove from the toy after the battery has been used up.
- Flat or dead batteries should be removed from the toy.
- Please remove the batteries if the toy is not going to be used for long time, or the leakage of the battery might cause rust or corrosion, which may damage the toy.
- Please replace the batteries when the toy won't work, re-activates frequently, or when its music weakened.
- Please be careful that the terminals of the batteries are not short-circuited.
- Protect the toy from water or dampness.
- Ensure power is turned off before changing batteries, and the battery changing must be done by an adult.
- The batteries are not included in this package, please purchase separately.
- Please dispose of the batteries or broken electronic products at an approved collection point. Such products cannot be disposed together with household waste.

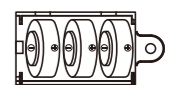
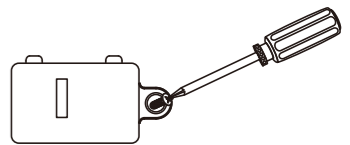

Uses 3X1.5V AG13 OR LR44 batteries (Not Included)



Please keep this instruction manual safe for future reference!

J'adore

建築工程車組

848578



電池安裝：

本產品採用3節AA 1.5V電池供電。

安裝電池時，結合圖示，按照如下步驟操作：

1. 用十字螺絲刀逆時針擰開螺絲(圖示1)；
2. 撥動卡扣打開電池蓋(圖示2)；
3. 按照正負極指示陸續放入電池(圖示3)；
4. 確認電池安裝正確後，放回電池蓋，並順時針擰緊固定螺絲(圖示4)；



注意：

務必將電池密封蓋完全鎖緊，不能讓產品入水，否則電池觸水導致漏電短路，雖不會造成人身傷害(電壓低)，但會導致產品損壞。

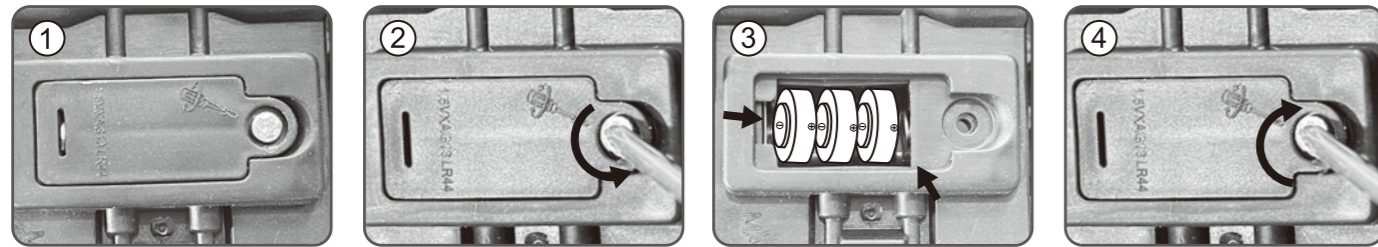

電池使用注意事項

- 電池應以正確的極性放入。
- 非充電電池不能充電。
- 充電電池在充電前應從玩具中取出。
- 充電電池只能在成人監護下充電。
- 不同類型的電池或者新舊電池不能混用。
- 不同類型不同新舊電池不能同時充電。
- 勿混用碳鋅、鹼性或鎳鎘充電電池。
- 勿將電池投入火中，可能引起爆裂或斜落。
- 電池用盡後請從玩具中取出。
- 長期不使用產品時，請把電池從玩具中取出。以免造成生銹或腐爛，進而損壞產品。
- 若產品光源變弱，發音變弱或忽然停止工作及重複啟動，請及時更換電池。
- 電源端子不得短路。
- 請避免玩具接觸水或者受潮。
- 請在電源關閉狀態下更換電池，電池更換必須由成人完成。
- 本包裝不含電池，請自行購買。
- 電池或者故障電子產品請送往獲准收集點處置。此類產品不能和生活垃圾一起丟棄。

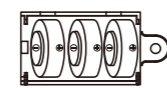
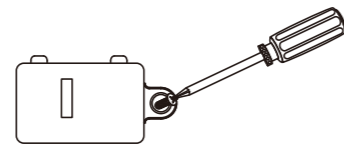

使用 3×1.5V
AG13或LR44
電池 (不包括)



請妥善保管此說明書，以備日後參考！

繁中

J'adore

建築工程車組

848578



電池安裝：

本產品採用3節AA 1.5V電池供電。

安裝電池時，結合圖示，按照如下步驟操作：

1. 用十字螺絲刀逆時針擰開螺絲(圖示1)；
2. 撥動卡扣打開電池蓋(圖示2)；
3. 按照正負極指示陸續放入電池(圖示3)；
4. 確認電池安裝正確後，放回電池蓋，並順時針擰緊固定螺絲(圖示4)；



注意：

務必將電池密封蓋完全鎖緊，不能讓產品入水，否則電池觸水導致漏電短路，雖不會造成人身傷害(電壓低)，但會導致產品損壞。

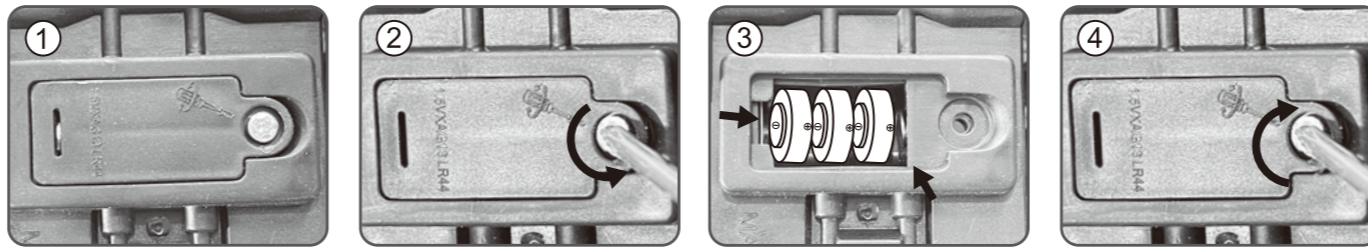

電池使用注意事項

- 電池應以正確的極性放入。
- 非充電電池不能充電。
- 充電電池在充電前應從玩具中取出。
- 充電電池只能在成人監護下充電。
- 不同類型的電池或者新舊電池不能混用。
- 不同類型不同新舊電池不能同時充電。
- 勿混用碳鋅、鹼性或鎳鎘充電電池。
- 勿將電池投入火中，可能引起爆裂或斜落。
- 電池用盡後請從玩具中取出。
- 長期不使用產品時，請把電池從玩具中取出。以免造成生銹或腐爛，進而損壞產品。
- 若產品光源變弱，發音變弱或忽然停止工作及重複啟動，請及時更換電池。
- 電源端子不得短路。
- 請避免玩具接觸水或者受潮。
- 請在電源關閉狀態下更換電池，電池更換必須由成人完成。
- 本包裝不含電池，請自行購買。
- 電池或者故障電子產品請送往獲准收集點處置。此類產品不能和生活垃圾一起丟棄。

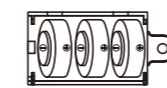
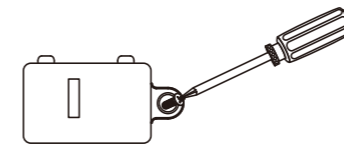

使用 3×1.5V
AG13或LR44
電池 (不包括)



請妥善保管此說明書，以備日後參考！

繁中

J'adore

建築工程車組

848578



電池安裝：

本產品採用3節AA 1.5V電池供電。

安裝電池時，結合圖示，按照如下步驟操作：

1. 用十字螺絲刀逆時針擰開螺絲(圖示1)；
2. 撥動卡扣打開電池蓋(圖示2)；
3. 按照正負極指示陸續放入電池(圖示3)；
4. 確認電池安裝正確後，放回電池蓋，並順時針擰緊固定螺絲(圖示4)；



注意：

務必將電池密封蓋完全鎖緊，不能讓產品入水，否則電池觸水導致漏電短路，雖不會造成人身傷害(電壓低)，但會導致產品損壞。

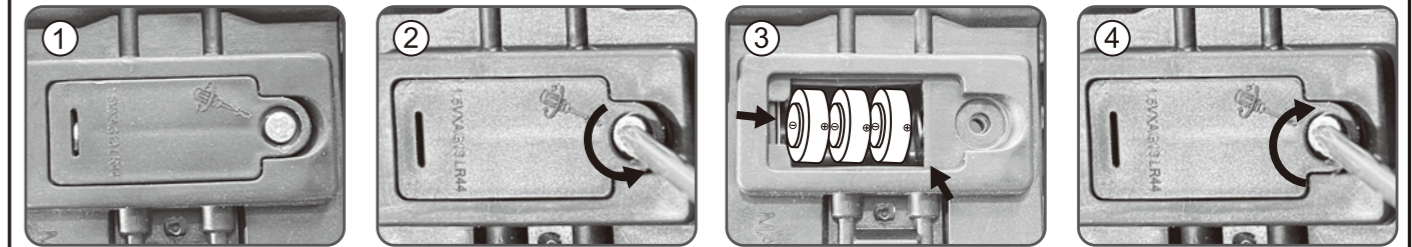

電池使用注意事項

- 電池應以正確的極性放入。
- 非充電電池不能充電。
- 充電電池在充電前應從玩具中取出。
- 充電電池只能在成人監護下充電。
- 不同類型的電池或者新舊電池不能混用。
- 不同類型不同新舊電池不能同時充電。
- 勿混用碳鋅、鹼性或鎳鎘充電電池。
- 勿將電池投入火中，可能引起爆裂或斜落。
- 電池用盡後請從玩具中取出。
- 長期不使用產品時，請把電池從玩具中取出。以免造成生銹或腐爛，進而損壞產品。
- 若產品光源變弱，發音變弱或忽然停止工作及重複啟動，請及時更換電池。
- 電源端子不得短路。
- 請避免玩具接觸水或者受潮。
- 請在電源關閉狀態下更換電池，電池更換必須由成人完成。
- 本包裝不含電池，請自行購買。
- 電池或者故障電子產品請送往獲准收集點處置。此類產品不能和生活垃圾一起丟棄。

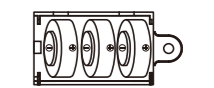
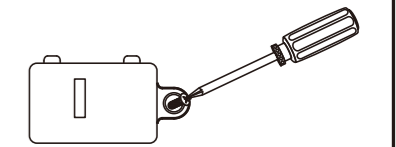

使用 3×1.5V
AG13或LR44
電池 (不包括)

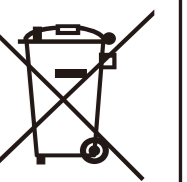

請妥善保管此說明書，以備日後參考！

繁中

J'adore

建築工程車組

848578



電池安裝：

本產品採用3節AA 1.5V電池供電。

安裝電池時，結合圖示，按照如下步驟操作：

1. 用十字螺絲刀逆時針擰開螺絲(圖示1)；
2. 撥動卡扣打開電池蓋(圖示2)；
3. 按照正負極指示陸續放入電池(圖示3)；
4. 確認電池安裝正確後，放回電池蓋，並順時針擰緊固定螺絲(圖示4)；



注意：

務必將電池密封蓋完全鎖緊，不能讓產品入水，否則電池觸水導致漏電短路，雖不會造成人身傷害(電壓低)，但會導致產品損壞。

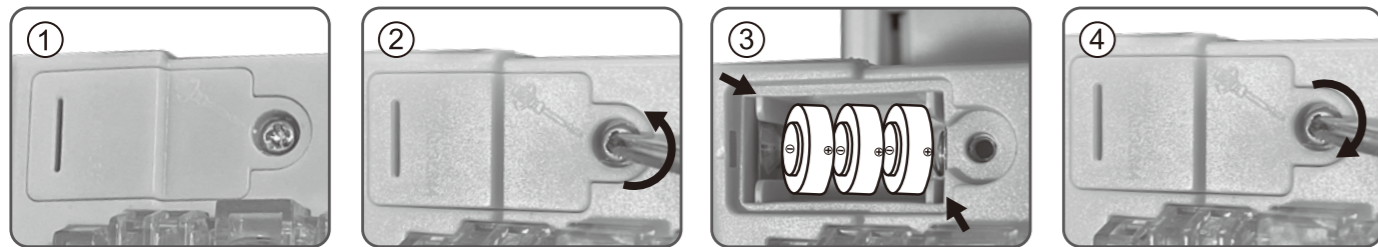

電池使用注意事項

- 電池應以正確的極性放入。
- 非充電電池不能充電。
- 充電電池在充電前應從玩具中取出。
- 充電電池只能在成人監護下充電。
- 不同類型的電池或者新舊電池不能混用。
- 不同類型不同新舊電池不能同時充電。
- 勿混用碳鋅、鹼性或鎳鎘充電電池。
- 勿將電池投入火中，可能引起爆裂或斜落。
- 電池用盡後請從玩具中取出。
- 長期不使用產品時，請把電池從玩具中取出。以免造成生銹或腐爛，進而損壞產品。
- 若產品光源變弱，發音變弱或忽然停止工作及重複啟動，請及時更換電池。
- 電源端子不得短路。
- 請避免玩具接觸水或者受潮。
- 請在電源關閉狀態下更換電池，電池更換必須由成人完成。
- 本包裝不含電池，請自行購買。
- 電池或者故障電子產品請送往獲准收集點處置。此類產品不能和生活垃圾一起丟棄。

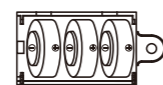
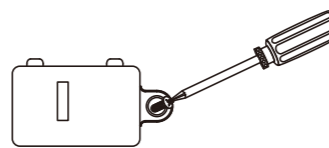

使用 3×1.5V
AG13或LR44
電池 (不包括)



請妥善保管此說明書，以備日後參考！

繁中

J'adore

建築工程車組

848578



電池安裝：

本產品採用3節AA 1.5V電池供電。

安裝電池時，結合圖示，按照如下步驟操作：

1. 用十字螺絲刀逆時針擰開螺絲(圖示1)；
2. 撥動卡扣打開電池蓋(圖示2)；
3. 按照正負極指示陸續放入電池(圖示3)；
4. 確認電池安裝正確後，放回電池蓋，並順時針擰緊固定螺絲(圖示4)；



注意：

務必將電池密封蓋完全鎖緊，不能讓產品入水，否則電池觸水導致漏電短路，雖不會造成人身傷害(電壓低)，但會導致產品損壞。

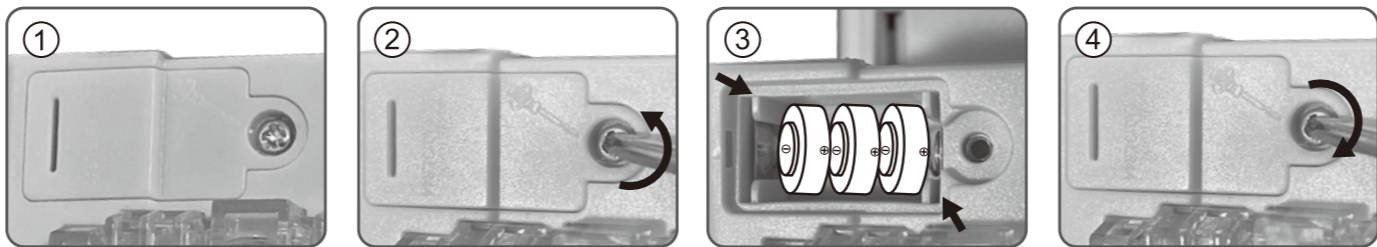

電池使用注意事項

- 電池應以正確的極性放入。
- 非充電電池不能充電。
- 充電電池在充電前應從玩具中取出。
- 充電電池只能在成人監護下充電。
- 不同類型的電池或者新舊電池不能混用。
- 不同類型不同新舊電池不能同時充電。
- 勿混用碳鋅、鹼性或鎳鎘充電電池。
- 勿將電池投入火中，可能引起爆裂或斜落。
- 電池用盡後請從玩具中取出。
- 長期不使用產品時，請把電池從玩具中取出。以免造成生銹或腐爛，進而損壞產品。
- 若產品光源變弱，發音變弱或忽然停止工作及重複啟動，請及時更換電池。
- 電源端子不得短路。
- 請避免玩具接觸水或者受潮。
- 請在電源關閉狀態下更換電池，電池更換必須由成人完成。
- 本包裝不含電池，請自行購買。
- 電池或者故障電子產品請送往獲准收集點處置。此類產品不能和生活垃圾一起丟棄。

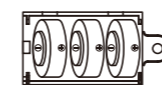
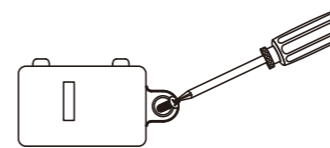

使用 3×1.5V
AG13或LR44
電池 (不包括)



請妥善保管此說明書，以備日後參考！

繁中

J'adore

建築工程車組

848578



電池安裝：

本產品採用3節AA 1.5V電池供電。

安裝電池時，結合圖示，按照如下步驟操作：

1. 用十字螺絲刀逆時針擰開螺絲(圖示1)；
2. 撥動卡扣打開電池蓋(圖示2)；
3. 按照正負極指示陸續放入電池(圖示3)；
4. 確認電池安裝正確後，放回電池蓋，並順時針擰緊固定螺絲(圖示4)；



注意：

務必將電池密封蓋完全鎖緊，不能讓產品入水，否則電池觸水導致漏電短路，雖不會造成人身傷害(電壓低)，但會導致產品損壞。

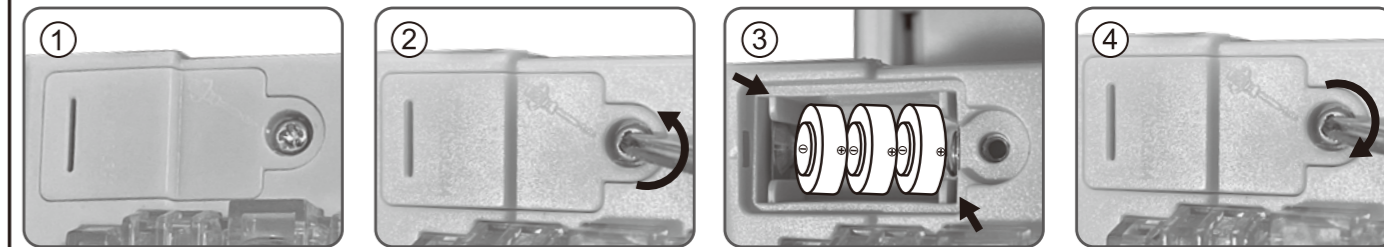

電池使用注意事項

- 電池應以正確的極性放入。
- 非充電電池不能充電。
- 充電電池在充電前應從玩具中取出。
- 充電電池只能在成人監護下充電。
- 不同類型的電池或者新舊電池不能混用。
- 不同類型不同新舊電池不能同時充電。
- 勿混用碳鋅、鹼性或鎳鎘充電電池。
- 勿將電池投入火中，可能引起爆裂或斜落。
- 電池用盡後請從玩具中取出。
- 長期不使用產品時，請把電池從玩具中取出。以免造成生銹或腐爛，進而損壞產品。
- 若產品光源變弱，發音變弱或忽然停止工作及重複啟動，請及時更換電池。
- 電源端子不得短路。
- 請避免玩具接觸水或者受潮。
- 請在電源關閉狀態下更換電池，電池更換必須由成人完成。
- 本包裝不含電池，請自行購買。
- 電池或者故障電子產品請送往獲准收集點處置。此類產品不能和生活垃圾一起丟棄。

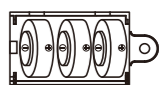
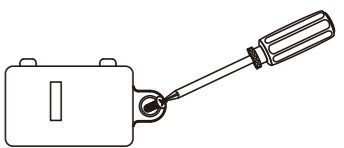

使用 3×1.5V
AG13或LR44
電池 (不包括)



請妥善保管此說明書，以備日後參考！

繁中