

# SAMSUNG

## Simple User Guide



AH81-174282-01

HW-S800D / HW-S801D / HW-S700D / HW-S701D



You can access the User guide on Samsung's on-line customer support center by scanning the QR code on the left. To see the manual on your PC or mobile device, download the manual in document format from Samsung's website. (<http://www.samsung.com/support>)

© 2024 Samsung Electronics Co., Ltd. All rights reserved.

Contact **SAMSUNG WORLD WIDE**

If you have any questions or comments relating to Samsung products, please contact the SAMSUNG customer care Centre.

Samsung Service Centre	Web Site
0800-32-9999 0809-00-5237 (B2B / Dealer)	<a href="http://www.samsung.com/tw/support">http://www.samsung.com/tw/support</a>

## SAFETY INFORMATION

### SAFETY WARNINGS

TO REDUCE THE RISK OF ELECTRIC SHOCK, DO NOT REMOVE THE COVER (OR BACK). NO USER-SERVICEABLE PARTS ARE INSIDE. REFER SERVICING TO QUALIFIED SERVICE PERSONNEL. Refer to the table below for an explanation of symbols which may be on your Samsung product.

	<b>CAUTION</b> <b>RISK OF ELECTRIC SHOCK. DO NOT OPEN.</b>
	This symbol indicates that high voltage is present inside. It is dangerous to make any kind of contact with any internal part of this product.
	This symbol indicates that this product has included important literature concerning operation and maintenance.
	Class II product : This symbol indicates that a safety connection to electrical earth (ground) is not required. If this symbol is not present on a product with a power cord, the product MUST have a reliable connection to protective earth (ground).
	AC voltage : Rated voltage marked with this symbol is AC voltage.
	DC voltage : Rated voltage marked with this symbol is DC voltage.
	Caution. Consult instructions for use : This symbol instructs the user to consult the user manual for further safety related information.

### WARNING

- To reduce the risk of fire or electric shock, do not expose this appliance to rain or moisture.
- Do not use liquid fumigators containing chemicals, such as mosquito repellent or air freshener, around the product. If steam comes in contact with the product surface or enters the product, it may cause stains or malfunction.

### CAUTION

- TO PREVENT ELECTRIC SHOCK, MATCH WIDE BLADE OF PLUG TO WIDE SLOT, FULLY INSERT.
- This apparatus shall always be connected to a AC outlet with a protective grounding connection.
- To disconnect the apparatus from the mains, the plug must be pulled out from the mains socket, therefore the mains plug shall be readily operable.
- Do not expose this apparatus to dripping or splashing. Do not put objects filled with liquids, such as vases, on the apparatus.

- To turn this apparatus off completely, you must pull the power plug out of the wall socket. Consequently, the power plug must be easily and readily accessible at all times.

## PRECAUTIONS

- Ensure that the AC power supply in your house complies with the power requirements listed on the identification sticker located on the bottom of your product. Install your product horizontally, on a suitable base (furniture), with enough space around it for ventilation (7-10 cm). Make sure the ventilation slots are not covered. Do not place the unit on amplifiers or other equipment which may become hot. This unit is designed for continuous use.  
To fully turn off the unit, disconnect the AC plug from the wall outlet. Unplug the unit if you intend to leave it unused for a long period of time.
- During thunderstorms, disconnect the AC plug from the wall outlet. Voltage peaks due to lightning could damage the unit.
- Do not expose the unit to direct sunlight or other heat sources. This could lead to overheating and cause the unit to malfunction.
- Protect the product from moisture (i.e. vases), and excess heat (e.g. a fireplaced) or equipment creating strong magnetic or electric fields: Unplug the power cable from the AC wall socket if the unit malfunctions. Your product is not intended for industrial use. It is for personal use only. Condensation may occur if your product has been stored in cold temperatures. If transporting the unit during the winter, wait approximately 2 hours until the unit has reached room temperature before using.
- The battery used with this product contains chemicals that are harmful to the environment. Do not dispose of the battery in the general household trash. Do not expose the battery to excess heat, direct sunlight, or fire. Do not short circuit, disassemble, or overheat the battery.  
CAUTION : Danger of explosion if the battery is replaced incorrectly. Replace only with the same or equivalent type.
- Make sure to rest the AC/DC Adapter flat on a table or the floor. If you place the AC/DC Adapter so that it is hanging with the AC cord input facing upwards, water or other foreign substances could enter the Adapter and cause the Adapter to malfunction.

## 01 CHECKING THE COMPONENTS

- Soundbar Main Unit
- Soundbar Remote Control
- Subwoofer
- Power Cord X 2 (Subwoofer, Soundbar)
- AC/DC Adapter
- HDMI to Micro HDMI Cable
- Wall Mount Guide
- Holder-Screw X 2
- Screw (M5 X L55) X 4
- Screw Anchor X 4
- Bracket-Wall Mount X 2

### NOTE

- For more information about the power supply and power consumption, refer to the label attached to the product. (Label: Bottom of the Soundbar Main Unit)
- To purchase additional components or optional cables, contact a Samsung Service Center or Samsung Customer Care.

## 02 PRODUCT OVERVIEW

### Top Panel of the Soundbar

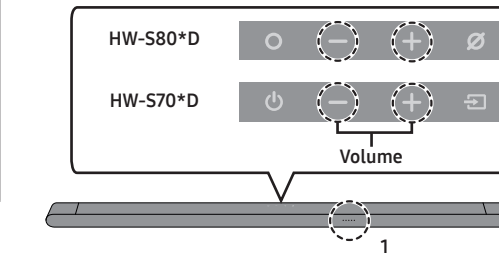

- (Multi Function) Button**  
In standby mode, press the **(Multi Function)** button to turn on the Soundbar. Press the **(Multi Function)** button to change the mode.
  - (Mic On/Off) Button**  
Press the button to turn the microphone on or off. When the microphone is off, the LED indicator will light red.
  - LED indicator**  
The LED Indicator flashes, glows, or changes color depending on the Soundbar's current mode or status.
  - (Power) Button**  
Turns the power on and off.
  - (Source) Button**  
Press the **(Source)** button to change the input source.
- To switch to Bluetooth Pairing state in "Bluetooth" mode, press and hold the **(Mic On/Off)** or **(Source)** button on the top of the Soundbar for more than 5 seconds.

### Rear Panel of the Soundbar

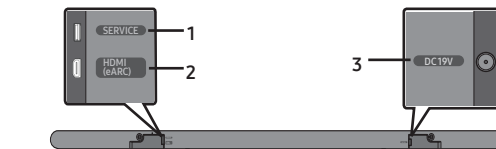

- SERVICE**  
Connect a USB storage device to upgrade the product's software.
- HDMI (eARC)**  
Connect to the HDMI jack on a TV.
- DC19V**  
Connect the AC/DC power adapter. (Power Supply In)

## 03 CONNECTING THE SOUNDBAR

### Connecting the power and units

#### Rear of Subwoofer

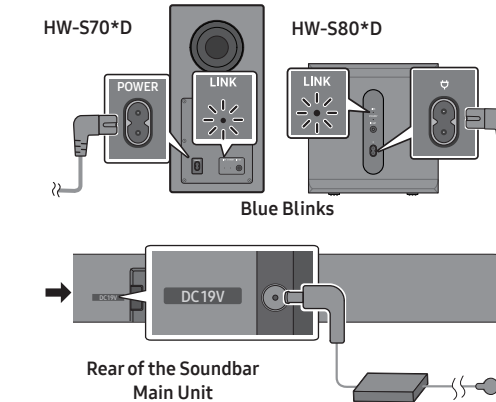

- The LINK LED indicator stops blinking and glows a solid blue when a connection is established between the Soundbar and the Wireless Subwoofer.

## 04 USING A WIRED CONNECTION

### Connecting using an HDMI to Micro HDMI Cable

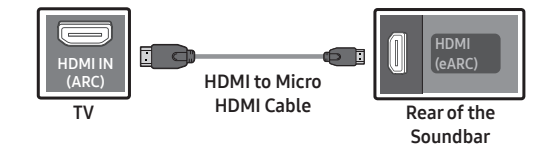

### NOTE

- When using an HDMI to Micro HDMI cable, take caution not to break the cable terminal.
- When the TV sound is not output, press the **(Multi Function)** / **(Source)** button at the top of the Soundbar or the **(Source)** button on the remote control to select the "TV ARC" mode.
- The recommended cable is an HDMI cable certified by HDMI.org.

### Using the Q-Symphony Function

When the Soundbar connects to a Samsung TV that supports the Q-Symphony function, you can play the sound simultaneously through the Soundbar and the TV. If you use the Q-Symphony function, the surround sound played on the TV allows you to enjoy a richer, more three-dimensional surround sound effect.  
When the Soundbar is connected, "Q-symphony" menu appears on the TV. (The message displayed may differ with the TV model.)  
(Settings (⚙️) → All Settings (⚙️) → Sound → Sound Output)

## 05 USING A WIRELESS CONNECTION

### Connecting via Bluetooth

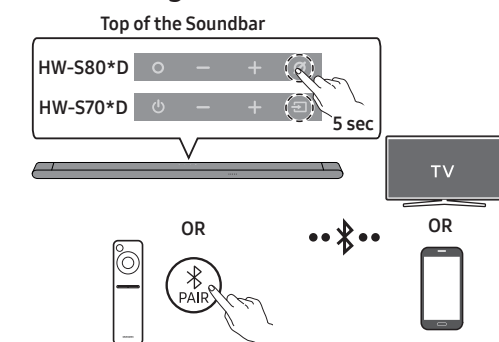

- Search for the Bluetooth device on your TV or mobile device.

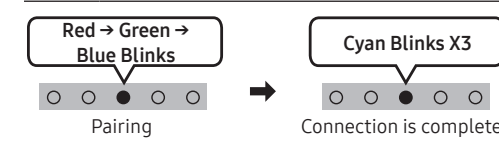

Ready to connect via Bluetooth.

### NOTE

- If asked for a PIN code when connecting a Bluetooth device, enter "0000".

### Connecting via Wi-Fi (Wireless Network)

- To connect a Soundbar to a mobile device via a wireless network (Wi-Fi), the SmartThings app is required.
- Connect your mobile device (smartphone, tablet, etc.) to the Wi-Fi network the TV is connected to.
  - Install and launch the SmartThings app on your mobile device (smartphone, tablet, etc.).
  - Follow the instructions in the app screen on the mobile device to connect the Soundbar to your Wi-Fi network.

## 06 TROUBLESHOOTING

Before seeking assistance, check the following.

### Soundbar does not turn on.

- Check whether the power cord of the Soundbar is correctly inserted into the outlet.

### If the subwoofer does not connect automatically

- Turn off the Soundbar main.
- Press and hold **ID SET** on the rear of the subwoofer for at least 5 seconds.

### The Soundbar indicator turns solid red. (HW-S80\*D model only)

- The microphone is turned off. Turn on the microphone.

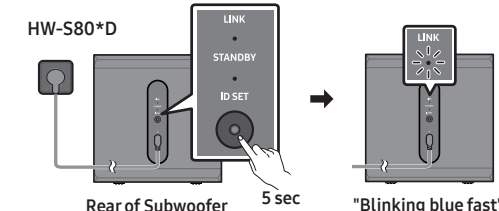
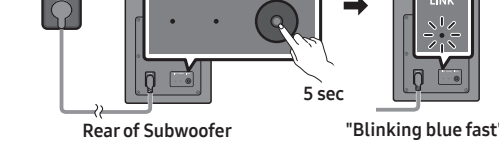

- Press the **Up** button on the remote control for 5 seconds.

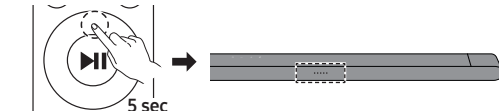

### LED indicator

- Check if the LINK LED is solid blue (connection complete).
  - The LINK LED indicator stops blinking and glows a solid blue when a connection is established between the Soundbar and the Wireless Subwoofer.

### Soundbar works erratically.

- After removing the power cord, insert it again.
- Try again after initializing the product.
- If there is no signal, the Soundbar automatically turns off after a certain period of time. Turn on the power.

### If the remote control does not work.

- Point the remote directly at the soundbar.
- HW-S80\*D : recharge the remote control.
- HW-S70\*D : Replace the batteries with new ones.

### The Soundbar indicator turns solid red. (HW-S80\*D model only)

- The microphone is turned off. Turn on the microphone.

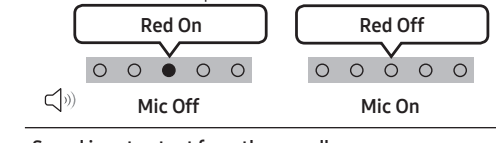

### Sound is not output from the soundbar.

- The volume of the Soundbar is too low or muted. Adjust the volume.
- When any external device (STB, Bluetooth device, mobile device, etc.) is connected, adjust the volume of the external device.
- For sound output of the TV, select Soundbar. (Samsung TV: Home (⏠) → Menu → Settings (⚙️) → All Settings (⚙️) → Sound → Sound Output → Select Soundbar)
- Remove the cable from the Soundbar and then reconnect it.

### Sound is not output from the subwoofer.

- Check whether the LED on the rear of the Subwoofer lights in blue. Reconnect it when the blue LED blinks or the red LED lights.

### If the TV is not connected via HDMI (eARC)

- Check whether the HDMI cable is correctly connected to the ARC terminal.
- Connection may not be possible due to the connected external device (set-top box, game console, etc.). Directly connect the Soundbar.
- HDMI-CEC may not be activated on the TV. Turn on the CEC on the TV menu. (Samsung TV: Home (⏠) → Menu → Settings (⚙️) → All Settings (⚙️) → Connection → External Device Manager → Anynet+ (HDMI-CEC) ON)

### Soundbar will not connect via Bluetooth.

- When connecting a new device, switch to "BT PAIRING" for connection. (Press the **PAIR** button on the remote control or press the **(Mic On/Off)** / **(Source)** button on the body for at least 5 seconds.)
- Reconnect it after removing the Bluetooth speaker list on the device to connect. (Samsung TV: Home (⏠) → Menu → Settings (⚙️) → All Settings (⚙️) → Sound → Sound Output → Bluetooth Speaker List)

### Sound drops out when connected via Bluetooth.

- Some devices can cause radio interference if they are located too close to the Soundbar. e. g. microwaves, wireless routers, etc.
- If your device that is connected via Bluetooth moves too far away from the soundbar, it may cause the sound to drop out. Move the device closer to the soundbar.
- If a part of your body is in contact with the Bluetooth transceiver or the product is installed on metal furniture, the sound may drop out. Check the installation environment and conditions for use.

### Soundbar will not connect to Wi-Fi.

- Make sure the wireless router is turned on and then reconnect the wireless router after rebooting.
- The soundbar will not connect if the wireless signal is too weak. Try moving the router closer to the soundbar, or eliminating any obstacles that are between the soundbar and the router, if possible.

### The soundbar does not turn on automatically with the TV.

- When you turn off the Soundbar while watching TV, power synchronization with the TV is disabled. First turn off the TV.

## 07 IMPORTANT NOTES ABOUT SERVICE

Figures and illustrations in this User Manual are provided for reference only and may differ from actual product appearance.

## 08 SPECIFICATIONS AND GUIDE

<b>Model Name</b> : HW-S800D / HW-S801D
<b>Weight</b> : 1.4 kg
<b>Dimensions (W x H x D)</b> : 1160.0 x 38.0 x 39.9 mm
<b>AMPLIFIER Rated Output power</b> : 130 W
<b>Subwoofer</b> PS-WS800D (HW-S800D), PS-WS801D (HW-S801D)
• <b>Weight</b> : 6.4 kg
• <b>Dimensions (W x H x D)</b> : 238.0 x 240.8 x 238.0 mm
• <b>AMPLIFIER Rated Output power</b> : 200 W
<b>Model Name</b> : HW-S700D / HW-S701D
<b>Weight</b> : 1 kg
<b>Dimensions (W x H x D)</b> : 890.0 x 38.0 x 39.9 mm
<b>AMPLIFIER Rated Output power</b> : 90 W
<b>Subwoofer</b> PS-WS705D (HW-S700D), PS-WS706D (HW-S701D)
• <b>Weight</b> : 6 kg
• <b>Dimensions (W x H x D)</b> : 205.0 x 353.0 x 302.0 mm
• <b>AMPLIFIER Rated Output power</b> : 160 W

<b>Operating Temperature Range</b> : +10 °C to +40 °C
<b>Operating Humidity Range</b> : 10 % to 80 %, non-condensing
<b>Storage Temperature Range</b> : -20 °C to +45 °C
<b>Storage Humidity Range</b> : 5 % to 95 %, non-condensing
<b>Supported play formats</b> Dolby 5.1ch / Dolby Digital Plus / Dolby TRUE HD / Dolby ATMOS / DTS 5.1ch / LPCM 8ch

### NOTE

- Samsung Electronics Co., Ltd reserves the right to change the specifications without notice.
- Weight and dimensions are approximate.
- HW-S800D / HW-S801D : DC19V, 28 W
- HW-S700D / HW-S701D : DC19V, 18 W
- PS-WS800D / PS-WS801D : AC 100-240V~ 50/60Hz, 26 W
- PS-WS705D / PS-WS706D : AC 110-240V~ 50/60Hz, 28 W

### Precaution : The Soundbar will restart automatically if you turn on/turn off Wi-Fi or Bluetooth.

To deactivate Wi-Fi connection: Press and hold the **CH LEVEL** button on the remote control of the Soundbar for more than 30 seconds to turn on or off the Wi-Fi connection.

To deactivate Bluetooth connection: Press and hold the **TONE CONTROL** button on the remote control of the Soundbar for more than 30 seconds to turn on or off the Bluetooth connection.



### [ENERGY STAR] ENERGY STAR qualified model only

- Your Samsung product is ENERGY STAR qualified in its factory default setting. Change to certain features, settings and functionality in this product can change the power consumption, possibly beyond the limits required for ENERGY STAR qualification.
- Environmental Protection Agency and Department of Energy. ENERGY STAR is a joint program of the Government agencies, designed to promote energy efficient products and practices. Refer to [www.energystar.gov](http://www.energystar.gov) for more information of the ENERGY STAR Program.

### ENERGY STAR qualified model only (The other models)

- As an ENERGY STAR Partner, Samsung has determined that this product or product models meets the ENERGY STAR guideline for energy efficiency.



# SAMSUNG

## 簡易使用指南



AH81-17428Z-01

HW-S800D / HW-S801D / HW-S700D / HW-S701D



您可以掃描左側的 QR 代碼，以存取 Samsung 線上客戶支援中心上的使用指南。  
若要在 PC 或行動裝置上查看手冊，請從 Samsung 網站下載文件格式的手冊。  
(<http://www.samsung.com/support>)

© 2024 Samsung Electronics Co., Ltd. 版權所有。

聯絡 SAMSUNG 網站

如果您對 Samsung 產品有任何問題或意見，歡迎與 SAMSUNG 客戶服務中心聯絡。

客戶服務中心	網站
0800-32-9999 0809-00-5237 (B2B / Dealer)	<a href="http://www.samsung.com/tw/support">http://www.samsung.com/tw/support</a>

## 安全資訊

### 安全警告

為降低觸電的風險，請勿取下外蓋 (或面板)。  
內部沒有任何使用者可維修的零件。維修作業請交由合格維修人員負責。  
請參閱以下表格，查看可能出現在 Samsung 產品上的符號說明。

	注意
	<b>有觸電的風險，請勿打開。</b> 此符號表示內部有高壓電。以任何方式碰觸本產品的任何內部零件均有危險。
	II 類產品：此符號表示不需要進行接地的安全連接。 若此符號沒有出現在含電源線的產品上，則該產品必須牢固連接到保護性接地 (地線)。
	交流電電壓：標記此符號的額定電壓是交流電電壓。
	直流電電壓：標記此符號的額定電壓是直流電電壓。
	注意：使用時須參照說明指示：此符號指示使用者查閱使用者手冊，以取得進一步的安全相關資訊。

### 警告

- 為降低火災或觸電的風險，請勿讓本設備接觸到雨水或濕氣。
- 請勿在產品附近使用含有化學物質的液體噴霧器，例如：驅蚊液或空氣清新劑。如果蒸氣接觸到產品表面或進入產品，可能會產生污漬或故障。

### 注意

- 為防止觸電，請將插頭較寬的金屬片對準較寬的插槽，完全插入。
- 本設備應一律使用保護性接地線連接到交流電源插座。
- 若要中斷本設備與音線的連接，必須將插頭從管線插座拔出，因此管線與插頭必須可輕易操作。
- 請勿讓本設備受到水瀉或水濺。請勿將盛滿液體的物體 (例如花瓶) 放在本設備上。
- 若要完全關閉本設備，必須從牆式插座拔下電源插頭。因此，電源插頭必須位於您隨時可以輕鬆操作的位置。

## 注意事項

- 請確保家中的交流電源符合本產品底部識別貼紙上所列的電源要求。在適當的底座 (傢俱) 上水平安裝本產品，並在其周圍留有足夠通風空間 (7~10 公分)。請確保通風槽未蓋住。請勿將裝置放在擴音器或其他可能會變熱的設備上。此裝置是針對長期使用所設計。若要完全關閉此裝置，請從牆式插座中拔下交流電插頭。若有很長的時間不打算使用本裝置，請拔下裝置的插頭。
- 在雷雨期間，請從牆式插座拔下交流電插頭。閃電所導致的高壓電可能會損壞本裝置。
- 請勿將裝置直接暴露在陽光下或其他熱源中。這可能會導致過熱並造成裝置故障。
- 或這會產生強力磁場或電場設備。如果裝置故障，將電線插頭從交流電牆式插座拔除。本產品不適用於工業用途。它僅可供個人使用。如果一直將產品存放在寒冷的溫度下，可能會發生霧化。如果在冬天期間運轉此裝置，請先等候約 2 小時，直到裝置達到室溫後再使用。
- 本產品所使用的電池包含有害環境的化學物質。請將電池棄置於一般家居垃圾。請勿讓電池過熱。直接受到日照或接近火源。請勿讓電池短路或過熱，或者拆解電池。注意：若不正確地更換電池，會有爆炸的危險。請只使用相同或同等類型的電池更換。
- 請務必將交流電/直流電變壓器平放在桌面或地面上。如果您將交流電/直流電變壓器的交流電線輸入端朝上懸掛，水或其他異物可能會進入變壓器，並造成變壓器故障。

## 01 檢查元件

• 有源音箱主裝置	• HDMI 對 Micro HDMI 纜線
• 有源音箱遙控器	• 牆面安裝螺桿
• 有源低音音箱	• 支撐螺絲 X 2
• 電源線 X 2 (有源低音音箱、有源音箱)	• 螺絲 (M5 X L55) X 4
• 交流/直流電變壓器	• 地腳螺絲 X 4
	• 掛牆托架 X 2

### 備註

- 如需更多關於電源和電力消耗的資訊，請參閱貼在本產品上的標籤。(標籤：有源音箱主裝置底部)
- 若要購買其他元件或選用禮券，請聯絡 Samsung 服務中心或 Samsung 客戶服務。

## 02 產品概覽

### 有源音箱的上方面板

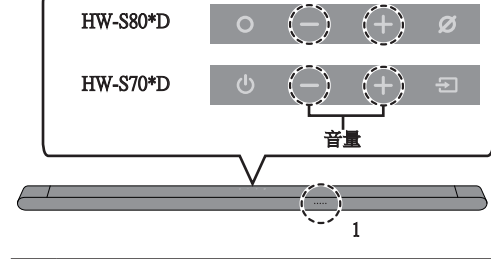

- (多功能) 按鈕**  
在待機模式下，按下 **○ (多功能)** 按鈕，以開啟有源音箱。  
按下 **○ (多功能)** 按鈕，以變更模式。
- ⊗ (麥克風開啟/關閉) 按鈕**  
按下按鈕可開啟或關閉麥克風。麥克風關閉時，LED 指示燈會發出紅色光。
- 1 LED 指示燈**  
LED 指示燈根據有源音箱的目前模式或狀態閃爍、發光或改變顏色。
- ⏻ (電源) 按鈕**  
開啟和關閉電源。
- ☑ (訊號源) 按鈕**  
按下 **☑ (訊號源)** 按鈕，以變更輸入訊號源。

- 如要在「Bluetooth」模式中切換至 Bluetooth 配對狀態，請按在有源音箱上方的 **⊗ (麥克風開啟/關閉)** 或 **☑ (訊號源)** 按鈕超過 5 秒。

### 有源音箱的後方面板



- SERVICE**  
連接 USB 儲存裝置，以升級產品的軟體。
- HDMI (eARC)**  
連接至電視上的 HDMI 插孔。
- DC 19V**  
連接交流電/直流電變壓器。(電源輸入)

## 03 連接有源音箱

### 連接電源和裝置

#### 有源低音音箱後側

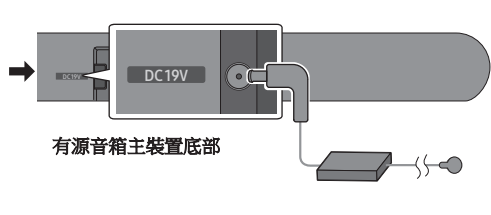
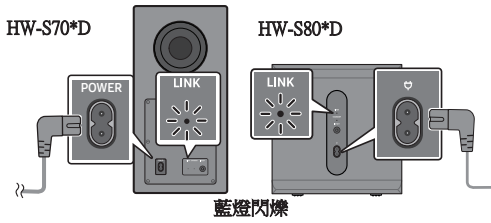

- 在有源音箱和無線有源低音音箱之間建立連接後，連結 LED 指示燈就會停止閃爍並持續亮著藍燈。

## 06 疑難排解

尋求協助之前，請先檢查下列項目。

### 有源音箱未開啟。

- 檢查有源音箱的電源線是否正確插入插座中。

### 若有源低音音箱沒有自動連接

- 關閉有源音箱電源。
- 按在有源低音音箱後側的 **ID SET** 至少 5 秒。

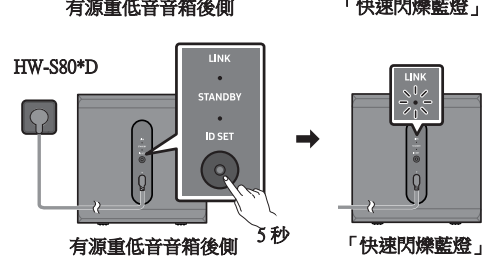
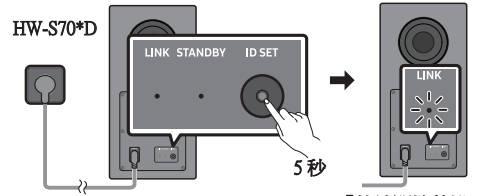

- 按下遙控器上的向上按鈕 5 秒。

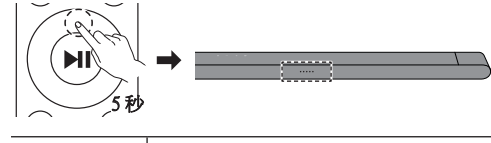

- 檢查連結 LED 燈是否持續亮著藍燈 (連接完成)。
  - 在有源音箱和無線有源低音音箱之間建立連接後，連結 LED 指示燈就會停止閃爍並持續亮著藍燈。

### 有源音箱不正常運作。

- 在拔下電源線後，重新插入。
- 在初始化本產品後重試。
- 若沒有訊號，有源音箱會在一段特定時間後自動關閉。開啟電源。

### 若遙控器沒有作用。

- 將遙控器直接對準有源音箱。
- HW-S800D：為遙控器充電。
- HW-S700D：更換新的電池。

### 有源音箱指示燈變為紅色恆亮。(僅 HW-S800D 機型適用)

- 麥克風已關閉。
- 開啟麥克風。

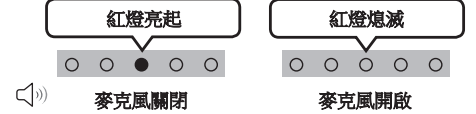

### 聲音未從有源音箱輸出。

- 有源音箱音量太低或靜音。調整音量。
- 連接任何外部裝置 (STB 藍牙裝置、行動裝置等) 時，請調整外部裝置的音量。
- 如高電視的聲音輸出，請選擇有源音箱。(Samsung TV：首頁 (⏴) → 功能表 → 設定 (⊗) → 所有設定 (☰) → 聲音 → 聲音輸出 → 選取有源音箱)
- 從有源音箱拔下纜線然後重新連接。

### 聲音未從有源低音音箱輸出。

檢查有源低音音箱後方的 LED 燈是否亮藍燈。若藍色 LED 燈閃爍或亮起紅色 LED 燈，請重新連接。

### 若電視沒有透過 HDMI (eARC) 連接

- 檢查 HDMI 纜線是否正確連接至 ARC 終端。
- 可能因為連接的外部裝置 (機上盒、遊戲主機等) 而無法進行連接。直接連接有源音箱。
- 可能沒有在電視上啟動 HDMI-CEC。在電視功能表上開啟 CEC。(Samsung TV：首頁 (⏴) → 功能表 → 設定 (⊗) → 所有設定 (☰) → 連接 → 外部裝置管理員 → Anynet+ (HDMI-CEC) 開啟)

### 有源音箱無法透過 Bluetooth 連接。

- 連接至新的裝置時，切換至「BT PAIRING」以進行連接。(按下遙控器上的 **PAIR** 按鈕，或按下機身上的 **⊗ (麥克風開啟/關閉)** / **☑ (訊號源)** 按鈕至少 5 秒。)
- 在要連接的裝置上移除藍牙揚聲器清單後重新連線。(Samsung TV：首頁 (⏴) → 功能表 → 設定 (⊗) → 所有設定 (☰) → 聲音 → 聲音輸出 → Bluetooth 喇叭清單)

### 透過 Bluetooth 連接時，聲音中斷。

- 有些裝置在太靠近有源音箱時會造成無線電干擾。例如，微波爐、無線路由器等。
- 若透過 Bluetooth 連接的裝置離有源音箱過遠，可能會造成聲音中斷。請將裝置移到更靠近有源音箱的位置。
- 若機身一部分接觸到 Bluetooth 收發器，或將本產品安裝在金屬傢俱上，則聲音可能會中斷。請檢查安裝環境和使用情況。

### 有源音箱無法透過 Wi-Fi 連接。

- 確認無線路由器已開啟，然後在重新開機後重新連線無線路由器。
- 若無線訊號太弱，有源音箱將無法連接。如有可能，請嘗試將路由器移到更靠近有源音箱位置，或清空有源音箱與路由器之間的任何障礙物。

### 有源音箱未透過電視自動開啟。

- 若您正在觀看電視時關閉有源音箱，會停用與電視之間的電源同步。請先關閉電視。

## 07 關於服務的重要注意事項

本使用者手冊中所提供的圖像僅供參考，實際產品外觀可能不同於圖像所示。

## 08 規格與指南

### 型號名稱：HW-S800D / HW-S801D

重量：1.4 公斤

尺寸 (寬 x 高 x 深)：1160.0 x 38.0 x 39.9 公釐

擴音器額定輸出功率：130 W

### 有源低音音箱

- PS-WS800D (HW-S800D)、PS-WS801D (HW-S801D)
- 重量：6.4 公斤
- 尺寸 (寬 x 高 x 深)：238.0 x 240.8 x 238.0 公釐
- 擴音器額定輸出功率：200 W

### 型號名稱：HW-S700D / HW-S701D

重量：1 公斤

尺寸 (寬 x 高 x 深)：890.0 x 38.0 x 39.9 公釐

擴音器額定輸出功率：90 W

### 有源低音音箱

- PS-WS705D (HW-S700D)、PS-WS706D (HW-S701D)
- 重量：6 公斤
- 尺寸 (寬 x 高 x 深)：205.0 x 353.0 x 302.0 公釐
- 擴音器額定輸出功率：160 W

操作溫度範圍：+10℃ 到 +40℃  
操作濕度範圍：-20℃ 到 +45℃  
存放濕度範圍：5% 至 95%，無冷凝

支持的播放格式  
Dolby 5.1ch / Dolby Digital Plus / Dolby TRUE HD / Dolby ATMOS / DTS 5.1ch / LPCM 8ch

### 備註

- Samsung Electronics Co., Ltd. 擁有權變更權，恕不另行通知。
- 重量與尺寸為近似值。
- 取得審驗證明之低功率射頻器材，非經核准，公司、商號或使用者均不得擅自變更頻率、加大功率或變更原設計之特性及功能。
- 低功率射頻器材之使用不得影響飛航安全及干擾合法通信；經發現有干擾現象時，應立即停用，並改善至無干擾時方得繼續使用。
- 前述合法通信，指依電信管理法規作業之無線電通信。低功率射頻器材須忍受合法通信或工業、科學及醫療用電波輻射性電機設備之干擾。
- 應避免影響附近雷達系統之操作。
- HW-S800D / HW-S801D：DC19V, 28 W
- HW-S700D / HW-S701D：DC19V, 18 W
- PS-WS800D / PS-WS801D：AC 100-240V~ 50/60Hz, 26 W
- PS-WS705D / PS-WS706D：AC 110-240V~ 50/60Hz, 28 W

### 注意事項：若您開啟/關閉 Wi-Fi 或 Bluetooth，有源音箱將會自動重新啟動。

停用 Wi-Fi 連接：  
按在有源音箱遙控器上的 **CH LEVEL** 按鈕超過 30 秒，以開啟或關閉 Wi-Fi 連接。

停用 Bluetooth 連接：  
按在有源音箱遙控器上的 **TONE CONTROL** 按鈕超過 30 秒，以開啟或關閉 Bluetooth 連接。



### [ENERGY STAR] ENERGY STAR qualified model only

- Your Samsung product is ENERGY STAR qualified in its factory default setting. Change to certain features, settings and functionality in this product can change the power consumption, possibly beyond the limits required for ENERGY STAR qualification.
- Environmental Protection Agency and Department of Energy, ENERGY STAR is a joint program of the Government agencies, designed to promote energy efficient products and practices.

Refer to [www.energystar.gov](http://www.energystar.gov) for more information of the ENERGY STAR Program.

### ENERGY STAR qualified model only (The other models)

- As an ENERGY STAR Partner, Samsung has determined that this product or product models meets the ENERGY STAR guideline for energy efficiency.

### RoHS

設備名稱：有源音箱 Equipment name	型號 (型式)：HW-S800D / HW-S801D Type designation (Type)					
	受限物質及其化學符號 Restricted substances and its chemical symbols					
單元 Unit	鉛 Lead (Pb)	汞 Mercury (Hg)	鎘 Cadmium (Cd)	六價鉻 Hexavalent chromium (Cr <sup>6+</sup> )	多溴聯苯 Polybrominated biphenyls (PBB)	多溴二苯醚 Polybrominated diphenyl ethers (PBDE)
電路板	-	○	○	○	○	○
外殼	○	○	○	○	○	○
金屬零件	-	○	○	○	○	○
揚聲器	-	○	○	○	○	○
電源供應器	-	○	○	○	○	○
配件(例：線材、遙控器)	-	○	○	○	○	○

備考1. "○" 係指該項受限物質之百分比含量未超出百分比含量基準值。  
Note 1: ○ indicates that the percentage content of the restricted substance does not exceed the percentage of reference value of presence.  
備考2. "-" 係指該項受限物質為排除項目。  
Note 2: The - indicates that the restricted substance corresponds to the exemption.

設備名稱：有源低音音箱 Equipment name	型號 (型式)：PS-WS800D / PS-WS801D Type designation (Type)					
	受限物質及其化學符號 Restricted substances and its chemical symbols					
單元 Unit	鉛 Lead (Pb)	汞 Mercury (Hg)	鎘 Cadmium (Cd)	六價鉻 Hexavalent chromium (Cr <sup>6+</sup> )	多溴聯苯 Polybrominated biphenyls (PBB)	多溴二苯醚 Polybrominated diphenyl ethers (PBDE)
電路板	-	○	○	○	○	○
外殼	○	○	○	○	○	○
金屬零件	-	○	○	○	○	○
揚聲器	○	○	○	○	○	○
配件(例：線材、遙控器)	-	○	○	○	○	○

備考1. "○" 係指該項受限物質之百分比含量未超出百分比含量基準值。  
Note 1: ○ indicates that the percentage content of the restricted substance does not exceed the percentage of reference value of presence.  
備考2. "-" 係指該項受限物質為排除項目。  
Note 2: The - indicates that the restricted substance corresponds to the exemption.

## 04 使用有線連接

### 使用 HDMI 對 Micro HDMI 纜線連接



### 備註

- 使用 HDMI 對 Micro HDMI 纜線時，請注意不要破壞環線接頭。
- 若電視聲音不是輸出，請按下有源音箱頂端的 **○ (多功能)** / **☑ (訊號源)** 按鈕或遙控器上的 **☑ (訊號源)** 按鈕，以選擇「TV ARC」模式。
- 建議的纜線為經 HDMI.org 認證的 HDMI 纜線。

### 使用 Q-Symphony 功能

將有源音箱連接至支援 Q-Symphony 功能的 Samsung TV，即可同時從有源音箱和電視播放聲音。使用 Q-Symphony 功能，電視播放的環繞音能讓您享受更加豐富、立體的環繞音效。  
當連接有源音箱時，「Q-Symphony」功能表會出現在電視上。(顯示的訊息可能因電視型號而異。)  
(設定 (⊗) → 所有設定 (☰) → 聲音 → 聲音輸出)

## 05 使用無線連接

### 透過藍牙連接

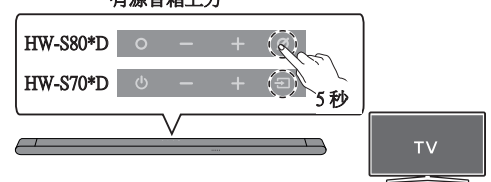

- 在您的電視或行動裝置上搜尋 Bluetooth 裝置。

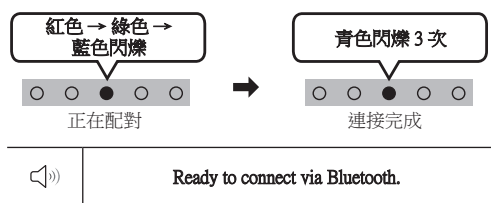

### 備註

- 若在連接 Bluetooth 裝置時要求輸入 PIN 碼，請輸入 <0000>。

### 透過 Wi-Fi (無線網路) 連線

- 若要透過無線網路 (Wi-Fi) 將有源音箱連線至行動裝置，請安裝 SmartThings 應用程式。
- 將行動裝置 (智慧型手機、平板電腦等) 連線至電視連接到 Wi-Fi 網路。
- 安裝並啟動行動裝置 (智慧型手機、平板電腦等) 上的 SmartThings 應用程式。
- 按照行動裝置上應用程式畫面中的說明以將有源音箱連線至 Wi-Fi 網路。