

# 3-TIER NSF XL COMMERCIAL ECOSTORAGE™ CART USER'S MANUAL

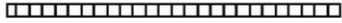

Please inspect box contents to ensure you have received all components. Note: The black circular plastic tops in between the shelves are used only for packaging purposes. They are NOT NEEDED. Please discard.



**A** Posts - x4



**B** Casters - x4  
(2 locking, 2 non-locking)



**C** Slip Sleeves - x15



**D** Shelf - x3



**E** Push Handle - x1

**CAUTION:** Failure to follow these guidelines may result in property damage or personal injury. Each shelf holds up to 500 lbs. with equal weight distribution without casters. Each shelf holds up to 200 lbs. with equal weight distribution on locked casters.

# Trinity 三層活動置物架 使用者手冊



請檢查包裝內容物以確認所有配件都未遺漏。  
注意：擱架之間的黑色圓型塑膠蓋，僅作為包裝使用。並非組裝所需零件，可丟棄回收處理。

**A** 桿子 - 4支



**B** 腳輪 - 4個 ( 2個有制動器、2個無制動器 )



**C** 固定套管 - 15個



**D** 擱架 - 3個

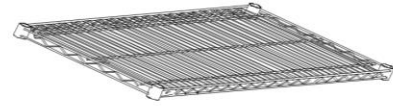

**E** 手推握把 - 1個



注意：未遵照這些指示操作會導致財產損失或人身傷害。在未安裝腳輪時，等重分配擺放物品，各層擱架最多可承重225公斤 ( 500磅 )。  
在腳輪安裝固定後，等重分配擺放物品，各層擱架最多可承重100公斤 ( 200磅 )。

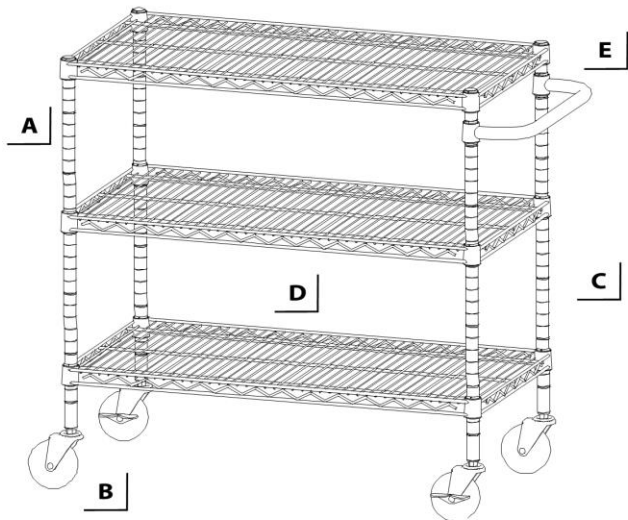
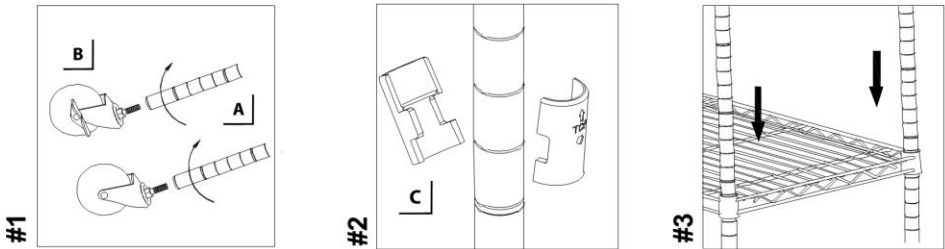

**步驟1**  
將桿子 (A) 與腳輪 (B) 鎖緊固定。確認有制動器的腳輪安裝於相同一側。

**步驟2**  
選定底部擱架 (D) 的希望高度。依固定套管 (C) 上的箭頭指示，以朝上的方向緊扣於桿子的凹槽。

**步驟3**  
將擱架 (D) 推滑至固定套管 (C) 上。視需要使用橡膠錘敲打以便固定擱架。重覆相同步驟安裝中間的擱架。

**步驟4**  
在安裝頂端擱架之前確認已將手推握把 (E) 安裝就位。

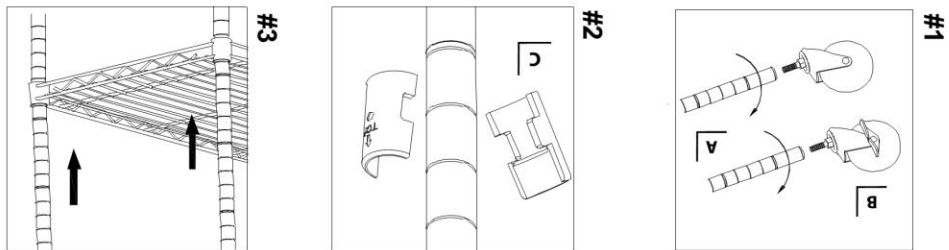

**Step 1**  
Screw casters (B) into the posts (A). Make sure that the locking casters are on the same side.

**Step 2**  
Choose the desired height of the bottom shelf (D). Snap sleeves (C) into the post grooves with the arrows facing up.

**Step 3**  
Slide the shelf (D) onto the sleeves (C). Use a rubber mallet if needed to secure the shelves. Repeat for the middle shelf.

**Step 4**  
Make sure to put the handle in place (E) before attaching the top shelf.

