

Waterpik® Water Flosser Model WF-10

Waterpik® 沖牙機
型號 WF-10

.....
www.waterpik.com

samcooper **design**

DO NOT PRINT

DATE: 04.26.2021
CLIENT: WATERPIK

FILENAME: 20030489-FAA_WF-10EC_Trad_IM_r3.indd
DESCRIPTION: WF-10 Instruction Manual
LANGUAGES: 2 [Eng, Trad Chinese]
FILE TYPE: Adobe InDesign CC
SCD JOB# / PREPARED BY: 21WPOH6842/ AM
CLIENT ROUND: r3

SCALE: 100%
UPC: N/A
SIZE: 14.0 x 4.5 flat; 7.0 x 4.5 folded
FORM NUMBER: 20030489-F AA
INK: Process Black
NOTES:

IMPORTANT SAFEGUARDS

READ ALL INSTRUCTIONS BEFORE USING.

- This product is for household use.

When using electrical products, especially when children are present, basic safety precautions should always be followed, including the following:

WARNING:

To reduce the risk of burns, electrocution, fire, or injury to persons:

- Do not charge this unit with any charging devices other than the one provided.
- If product is opened/disassembled for ANY reason, warranty is VOID.
- Do not use this product if it has a damaged cord or plug, if it is not working properly, if it has been dropped or damaged, or dropped into water. Contact Water Pik, Inc. at www.waterpik.com or InternationalService@waterpik.com.
- If the cord set is damaged, it must be replaced by a special cord set available from the manufacturer or its service agent.
- Do not direct water under the tongue, into the ear, nose or other delicate areas. This product is capable of producing pressures that may cause serious damage in these areas.
- Use this product only as indicated in these instructions or as recommended by your dental professional.

- Magnetic field: Pacemakers and similar implanted medical devices may be affected by magnet.
- Only use tips and accessories that are recommended by Water Pik, Inc.
- Do not drop or insert any foreign object into any opening on the product.
- Keep charging unit and cord away from heated surfaces.
- Do not use this product outdoors or operate where aerosol (spray) products are being used or where oxygen is being administered.
- Do not use iodine, saline (salt solution), or water insoluble concentrated essential oils in this product. Use of these can reduce product performance and will shorten the life of the product. Use of these products may void warranty.
- Remove any oral jewelry prior to use of this product.
- Do not use if you have an open wound on your tongue or in your mouth.
- If your physician advised you to receive antibiotic premedication before dental procedures, you should consult your dentist before using this instrument or any other oral hygiene aid.

- Fill reservoir with warm water or other dental professional recommended solution only.
- This appliance is not intended for use by persons (including children) with reduced physical, sensory or mental capabilities, or lack of experience and knowledge, unless they have been given supervision or instruction concerning the use of the appliance by a person responsible for their safety.
- Children should be supervised to ensure that they do not play with the appliance.
- There are no consumer serviceable parts in this appliance and it does not require maintenance.

SAVE THESE INSTRUCTIONS

Product Description	5
Getting Started	6
Cleaning and Troubleshooting Your Waterpik® Water Flosser	9
Battery Removal	10
Limited Two-Year Warranty	11

1. Tip rotator
2. Power button
3. Mode/pressure button
4. Battery charge indicator
5. Charging contacts
6. Tip
7. Tip eject button
8. Reservoir fill door
9. Reservoir

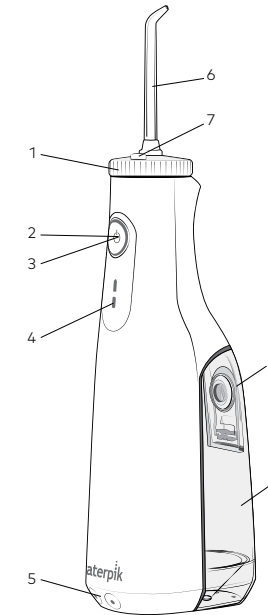

Power Cord
20024431-1 White
20024431-2 Black

**TIPS**

- A. Orthodontic Tip***
- Braces/General use
- B. Pik Pocket™ Tip***
- Periodontal Pockets/Furcations
- C. Plaque Seeker™ Tip***
- Implants/Crowns/Bridges/
Retainers/General use

D. Toothbrush Tip*

- General use

E. Classic Jet Tip**

- General use

F. Tongue Cleaner**

- Fresher breath

G. Travel Plug

- Keeps excess water from
draining out while traveling

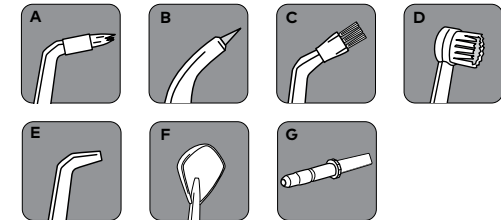
NOT ALL TIPS INCLUDED IN ALL MODELS

*Replace Every 3 months **Replace Every 6 months

To find detailed information about tips, other accessories, and product usage please visit our website at www.waterpik.com or email at InternationalService@waterpik.com.

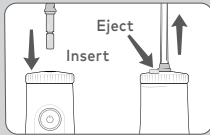
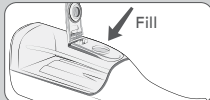
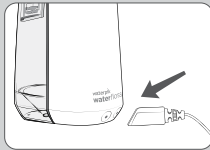

Charging Unit Prior to First Use

Plug the power cord into the wall and place the magnetic charger on the front of the unit for approximately 4 hours (see image). **Ensure contacts on BOTH the cord and unit are clean and dry before connecting the charger.** The LED light will display a single, rapid blink every 3 seconds when unit is fully charged and the charger is connected. A full charge will last for approximately 1 week of typical use. When the batteries are in need of charging (approximately 30% charge left) the charge indicator light will blink 8 times quickly after use to indicate that you should recharge the unit. A complete recharge will take 3-4 hours. If you use your Water Flosser once a day or less, it is recommended you charge it once a week. If you use it twice a day or more, charge the unit more frequently.

Filling the Reservoir

Remove the magnetic power cord from the unit prior to filling reservoir and product use. Lift flip top on reservoir and fill the reservoir with lukewarm water.

Inserting and Removing Tips

Insert tip into the center of the knob at the top of the Water Flosser handle. Press firmly until the tip clicks into place. To remove the tip from the handle, press the tip eject button and pull tip from the handle.

CAUTION: Do not press tip eject button while unit is running.

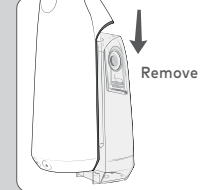
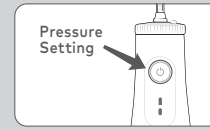

Adjusting the Pressure Setting

- 3 pressure settings;
- Short press to power on and switch setting; long press to power off and activate memory setting;
- LED: Blink 8 times quickly: the batteries are in need of charging.
Blink every 3 seconds: the batteries are charging.
Stay lit: the batteries are fully charged.

Recommended Technique

Lean low over sink and place tip in mouth. Aim the tip toward gumline, and turn the unit ON (I).

For best results, start with the back teeth and work toward the front teeth. Glide tip along gumline and pause briefly between teeth. Continue until you have cleaned the inside and outside of both the upper and lower teeth.

Direct the jet stream at a 90-degree angle to your gumline. **Slightly close lips to avoid splashing** but allow water to flow freely from mouth into the sink. Keep unit upright during use for best results.

When Finished

Turn the unit off. Empty any liquid left in the reservoir.

If desired, the reservoir may be removed from the power handle by simply pulling down on the reservoir to remove.

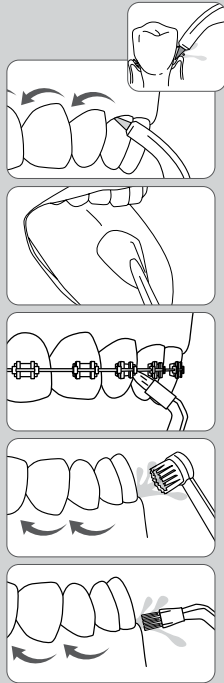

NOTE: NOT ALL TIPS INCLUDED WITH ALL MODELS.

TIP USAGE

Pik Pocket™ Tip

The Pik Pocket™ tip is specifically designed to deliver water or anti-bacterial solutions deep into periodontal pockets.

To use the Pik Pocket™ tip, **set the unit to the lowest pressure setting**. Place the soft tip against a tooth at a 45-degree angle and gently place the tip under the gumline, into the pocket.

Tongue Cleaner Tip

Set to lowest pressure setting, place tip in the center/middle of your tongue about half way back. Pull forward with light pressure. Increase pressure as you prefer.

Orthodontic Tip

To use the orthodontic tip, gently glide tip along gumline, pausing briefly to lightly brush area between teeth and all around orthodontic bracket, before proceeding to the next tooth.

Toothbrush Tip

Place the toothbrush tip in mouth with the brush head on the tooth at the gumline. The toothbrush tip can be used with or without toothpaste. Using a **light pressure** (bristles should not bend) massage the brush back and forth with very short strokes – much like you would with a manual toothbrush.

Plaque Seeker™ Tip

To use the Plaque Seeker™ tip, place the tip close to the teeth so that the bristles are gently touching the teeth. Gently glide tip along gumline, pausing briefly between teeth to gently brush and allow the water to flow between the teeth.



Using Mouthwash and Other Solutions

Your Waterpik® Water Flosser can be used to deliver mouthwash and antibacterial solutions. For ease of adding other solutions remove the reservoir (see "When Finished" section) and add from top opening on reservoir. If you are adding additional water you may replace the reservoir and fill reservoir fully with the fill door. After using any special solution, rinse unit to prevent clogging by partially filling reservoir with warm water and running unit with tip pointed into sink until unit is empty.

Cleaning

Never immerse unit in water. Before cleaning, unplug from the electrical outlet. Clean the product when necessary by using a soft cloth and mild non-abrasive cleanser to wipe exterior.

The water reservoir is removable for easy cleaning and is top rack dishwasher safe.

It is recommended that the reservoir is removed and cleaned weekly.

Removing Hard Water Deposits / General Cleaning

Hard water deposits may build up in your unit, depending on the mineral content of your water. If left unattended, it can hinder performance. Cleaning internal parts: add 1 tablespoon of white vinegar to a full reservoir of warm water. Point the handle and tip into sink. Turn unit ON and run until reservoir is empty. Rinse by repeating with a full reservoir of clean warm water.

This process should be done every 1 to 3 months to ensure optimal performance.

Battery Care and Disposal

If the Water Flosser is to be stored for an extended period of time (six months or more), be sure to fully charge it prior to storage. The unit contains a Nickel Metal Hydride battery. At the end of the battery life, please recycle the unit at your nearest recycle center per local or state requirements. The battery is not replaceable.

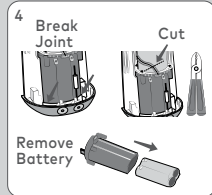
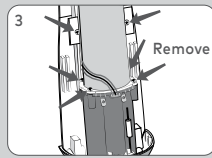
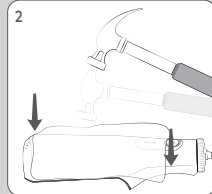
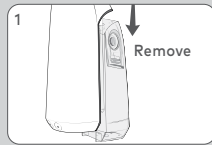

The product contains battery and/or recyclable electronic waste. In order to protect the environment, please do not dispose along with household waste. When battery life ends, please dispose or recycle according to local administrative regulations. Please contact local waste administrative department for any question.

If you tend to dispose the battery on your own, for example, for WF-10 model, please follow below steps to remove the battery:

1. Power off the device, remove reservoir.
2. Wrap in a towel and hit with a hammer to break the joint between the front, rear, and lower housings.
3. Remove 2 screws holding pump assembly to rear cover and 4 screws holding battery housing to pump assembly.
4. Carefully break the joint between the battery housing and rear cover.
Cut battery wires (careful not to short positive and negative wires together) and remove battery.

The removed battery should be disposed safely by special recycling center.

Warning: The battery of this product is not replaceable. Please do not disassemble the product unless you want to dispose it. Otherwise the warranty service will be void.

Service Maintenance

Waterpik® Water Flossers have no consumer-serviceable electrical items and do not require routine service maintenance. For all accessories go to www.waterpik.com or contact InternationalService@waterpik.com.

Refer to the serial and model numbers in all correspondence. These numbers are located on the bottom of your unit. Replacement tips can be purchased from www.waterpik.com or contact InternationalService@waterpik.com.

Water Pik, Inc. warrants to the original consumer of this new product that it is free from defects in materials and workmanship for 2 years from the date of purchase.

Consumer will be required to submit the original purchase receipt as proof of purchase date and if requested, the entire product, to support a warranty claim. Water Pik, Inc. will replace at its discretion the product, which in its opinion is defective, provided the product has not been abused, misused, altered or damaged after purchase, was used according to instructions, and was used only with accessories or consumable parts approved by Water Pik, Inc. This limited warranty excludes accessories or consumable parts such as tips, etc. **Use with improper voltage will damage product and VOID warranty.**

This warranty gives you specific legal rights. You may also have other rights that vary, depending on the law in your place of residence.

重要安全事項

請在使用前閱讀所有說明。

- 本產品供家庭使用。

當使用電氣產品時，尤其有兒童在場時，請務必遵循下列基本的安全防範措施：

警告：

為降低燒傷、觸電、火災或個人生命傷害的風險，請謹記：

- 除提供的充電設備外，請勿使用其它充電設備為本機充電。
- 如因為任何原因打開/拆卸產品，恕不保修。
- 如果產品電源線或插頭損壞、或產品工作不正常、或產品被摔、損壞或掉入水中，不要使用它。Water Pik, Inc.聯絡方式：www.waterpik.com，或InternationalService@waterpik.com。
- 如電源線損壞，則必須使用製造商或其服務代理商提供的專用電源線進行更換。
- 切勿將水注入舌下，耳朵，鼻子或其他敏感部位。本產品產生的壓力可能對這些部位造成嚴重傷害。
- 按照本說明書的規定或者您牙醫的建議使用本設備。

- 磁力傳感器：起搏器及類似植入式醫療設備可能受磁性影響。
- 僅允許使用Waterpik®公司推薦的刷頭和附件。
- 切勿在任何開口或者軟管中放入或插入異物。
- 電線須遠離加熱表面。
- 切勿在戶外、使用氣霧劑（噴霧器）或供氧的場所使用或操作本產品。
- 不要在產品中使用碘或水不溶性濃縮精油。使用它們能降低產品性能並縮短產品壽命。使用這些東西可能會讓保修作廢。
- 使用本產品前摘除所有牙飾。
- 如若口腔或舌頭有傷口，請勿使用。
- 如果醫師或心臟病專家建議您在牙療前服用抗生素，應在使用本儀器前或其他任何口腔衛生輔助設備之前，向您的牙醫諮詢。
- 用水或牙醫推薦的溶液將水箱注滿。

- 除非有安全負責人在旁邊監護或指導，嚴禁體弱、智障或知覺欠佳的人或缺乏經驗和知識的人（包括兒童）使用此設備。
- 請避免兒童玩弄本設備。
- 本設備中無消費者可維修的配件，本設備不需要維修。

務必謹記上述說明。

產品說明	15
使用前的準備事宜	16
Waterpik® 沖牙機的清洗和故障排除	19
取出電池	20
兩年有限質保	21

1. 噴頭更換按鈕
2. 電源開關
3. 模式按鈕
4. 電池電量指示
5. 充電口
6. 噴/刷頭
7. 刷頭彈出按鈕
8. 水槽補水口
9. 水箱



20024431-1 White
20024431-2 Black

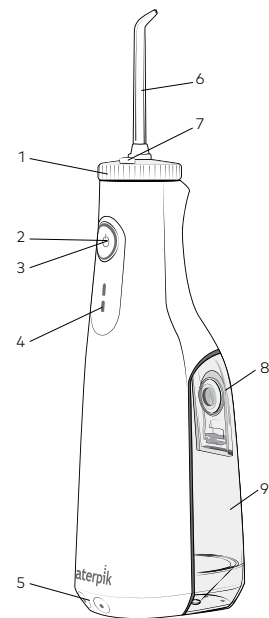

噴/刷頭

- | | |
|-------------------------|-------------|
| A. 矯正噴頭* | D. 牙刷頭* |
| - 牙齦 | - 一般用途 |
| - 一般用途 | E. 標準噴頭** |
| B. Pik Pocket 深層/牙周噴頭* | - 一般用途 |
| - 牙周/牙根分叉 | F. 舌苔清洗噴頭** |
| C. Plaque Seeker 牙菌斑噴頭* | - 清潔口腔 |
| - 植牙/ | G. 旅行插頭 |
| - 齒冠 | - 避免旅行期間 |
| - 牙橋 | - 多餘水分流出 |
| - 一般用途 | |

並非所有的型號均包含所有類型的刷頭。

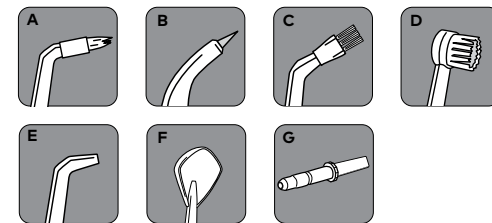

*每3個月進行更換 **每6個月進行更換

有關刷頭、其他配件和產品使用的詳細資訊，請訪問我們的網站 www.waterpik.com，或寄送電郵至 InternationalService@waterpik.com。

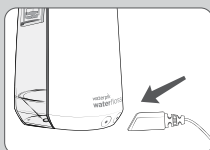

適配器並非此設備
標準配件。

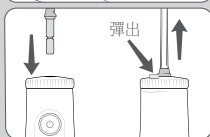
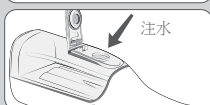
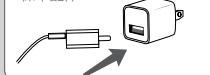

第一次使用前請為本機充電

將電源線插入牆面插頭，然後將磁性充電器放在本機前約4小時（見圖示）。連接充電器前，請確保電源線和本機觸點處於清潔乾燥狀態。

本機充滿電及充電器連接成功後，LED指示燈將每3秒快速閃爍

一次。充滿一次電可供約一周正常使用。當電池需要

充電（約剩餘30%電量）時，充電指示燈將在使用後快速閃爍8次，

提醒您為本機充電。充滿電約需3-4小時。如果您每天使用水牙線（Water Flosser）或以下，建議您每週充電一次。如每天使用兩次以上，則充電頻率需提高。

水槽補水

在補充水量水和使用本品前，請務必先將電源線從機器上拔出。提起水槽頂蓋，並將溫水灌入水槽中。

噴/刷頭的插入與移除

將噴/刷頭插入沖牙機手柄的中心，用力向下按，直到噴/刷頭卡入到位。要從手柄上取下噴/刷頭，按壓噴頭彈出按鈕即可。

當心：設備運行時，請勿按噴頭彈出按鈕。

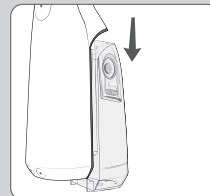

調整壓力設置

1. 3 壓力設置；
2. 短按啟動電源並切換至設置；長按關閉電源並激活內存設置；
3. LED：快速閃爍8次：電池需要充電。
每3秒閃爍：電池充電中。常亮：電池已充滿。

推薦技巧

倚靠水池身體壓低，將噴頭放入嘴中。將噴頭對準牙齦線，並啟動設備（I）。為獲得最佳效果，從後牙開始朝門牙方向清洗。將噴頭沿牙齦線移動，並在齒間短暫停留。繼續清洗，直到上齒和下齒的內外側均已洗淨。把噴頭放在口中，使噴射流與牙齦線呈90度角。微微閉合嘴唇，避免液體飛濺，同時可讓液體順利從口中流入水池。使用過程中，請保證本機直立，以便獲得最佳使用體驗。

清洗完成後

關閉設備。倒掉殘留在水箱中的所有液體。拔掉設備的電源插頭。
注意：如果除了水之外您還使用漱口水或其他溶液，請參考「使用漱口水和其他溶液」部分。

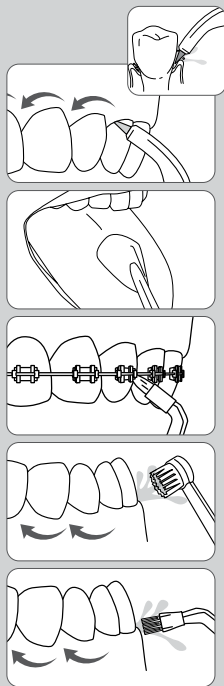

注意：並非所有的型號均包含所有類型的刷頭。

噴/刷頭的用法

Pik Pocket™ 深層/牙周噴頭

Pik Pocket™ 深層/牙周噴頭專為將水或抗菌溶液輸送至深層牙周袋而設計。

使用PikPocket深層/牙周噴頭時，請務必將產品設置為最小壓力值。將柔性噴頭正對牙齦線呈45度角靠在一顆牙上，輕緩地移動噴頭直至其置於牙齦偏下位置，進入牙周袋內。開啟設備，沿牙齦線滑動清洗。

舌苔清洗噴頭

使用舌苔清洗噴頭時，請將壓力設置為最小值。將刷頭放在舌前後部等距的中央/中線位置，然後開啟沖牙機。從低壓開始向前推動。根據您的喜好增加壓力。

矯正噴頭

使用矯正噴頭時，沿著牙齦線輕輕滑動噴頭，在齒間和矯正托槽周圍所有部位短暫停留並輕刷，然後滑動噴頭清洗下一顆牙齒。

牙刷頭

將牙刷頭置於口腔內，並在牙齦線處將刷頭對準牙齒。牙刷頭可與牙膏配合使用，也可不使用牙膏。開啟沖牙機，讓水流通過刷頭。用低壓力（不應彎曲刷毛）並以極小的幅度來回刷動牙刷頭——就像使用傳統的牙刷一般。

Plaque Seeker™ 牙菌斑噴刷頭

使用Plaque Seeker™ 牙菌斑噴刷頭時，將刷頭貼近牙齒使得刷毛能夠輕觸牙齒。沿著牙齦線輕柔地滑動刷頭，在牙縫處稍作停留並輕輕地刷動，讓水流經牙縫。



使用漱口水及其它方案

Waterpik®水牙線可用漱口水及其它抗菌溶劑。為便於添加其它液體，可拆下水槽（見“完成時”章節），並從水槽頂部灌入。

如要繼續添加水，您可更換水槽並通過補水口添水。使用

任何特殊溶液後，請沖洗本品以免堵塞，可在水槽中灌入部分溫水，並將噴頭對向水池後打開運行，直至設備內水空。

清潔

請勿將本機浸入水中。清潔前，請將電源插頭從電源插座中拔下。必要時可使用軟佈和溫和的非腐蝕式清潔劑擦拭外部。

水槽可拆卸以便清洗，且可安全用於洗碗機。建議每週拆下水槽進行清潔。

清除硬水沉積/一般清潔

硬水沉積物可能會在您的電器上積累，這取決於水中的礦物質含量。如果對此不管，會降低電器的性能表現。

清潔內部零件：將水箱灌滿溫水，並加入2湯匙白醋。把手柄和噴頭指向盥洗池內。打開電器，讓其運行，直到水箱變空。再向水箱加滿乾淨溫水，重複上述操作來進行沖洗。

應每隔1至3個月重複該操作，以確保最佳性能。

電池保養及處置

如水牙線存放時間較長（六個月以上），請務必充滿電後再收起保存。本機含Nickel Metal Hydride電池。電池壽命到期後，請根據當地或州/國家要求在距您最近的回收中心將本機回收處理。電池不可更換。

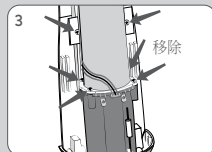
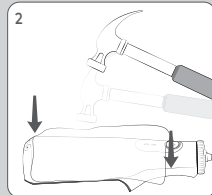

產品包含電池和/或可回收電子垃圾。為保護環境，請勿將其與家庭垃圾一起處置。電池壽命到期後，請根據當地行政法規進行處理或回收。如有任何疑問，請聯繫當地廢棄物管理部門。

例如，如果您計劃自己處理電池，則針對for WF-10型號，請按以下步驟拆下電池：

1. 給設備關機，拆除水槽。
2. 使用一條毛巾進行包裹，然後用錘子敲碎前後和下殼件的連接。
3. 拆下後蓋處固定泵頭的2顆螺母，和將電池盒固定在泵頭上的4顆螺母。
4. 小心地斷開電池盒和後蓋間的連接。切斷電池線（小心不要將正負極短線連在一起）並取出電池。拆下的電池應交由專業的回收中心安全處置。

警示：本產品電池不可更換。除非想要處置本品，請勿拆卸本品。否則保修服務將失效。

維護服務

Waterpik®沖牙機不含任何需用戶維護的電氣零件，且無需例行維護操作。有關配件資訊，請查看www.waterpik.com，或聯繫 InternationalService@waterpik.com。

通訊時請說明序列號和型號。該號碼位於您產品的底部。替換噴頭必須在 www.waterpik.com 購買，或聯繫 InternationalService@waterpik.com。

Water Pik, Inc. 向這款新產品的原始消費者提供保證，自購買之日起2年內，不存在材料和工藝方面的缺陷。消費者將被要求提交原始購買收據以證明購買日期，並且如有需要，須提交整個產品，以支持保修索賠。Water Pik, Inc.將自行決定更換其認為有缺陷的產品，前提是確定產品在購買後未被濫用、誤用、塗改或損壞，並且根據說明來使用，僅使用Water Pik, Inc.認可的配件或消耗部件。

此有限保修不包括附件或消耗部件，如噴/刷頭等。使用的電壓不正確會損壞產品並讓保修作廢。

本保修賦予您特定的法律權利。您可能擁有其他權利，具體取決於您居住地的法律。

waterpik®

**Water Pik, Inc., a subsidiary of
Church & Dwight Co., Inc.** 

1730 East Prospect Road
Fort Collins, CO 80553-0001 USA
844-821-4873

www.waterpik.com

Designed and tested in the USA. Made in China.
美國設計及測試。中國製造。

Form No. 20030489-F AA
©2021 Water Pik, Inc.